

WEBSTER SCHOOL

Sumner and Monroe Street N. E.

1931

Miss Ruth M. Cecil, Principal

Originally Erected	1880
Number of Class Rooms	16
Number of Special Rooms	1
Enrollment	511

WEBSTER SCHOOL

A one and two story brick structure of quick burning interior construction.

DETAILED REPORT

OCCUPANCY: This building contains only ordinary class rooms except for teachers lunch room in basement.

CARE AND MAINTENANCE: Building in fairly good repair. Housekeeping is good.

EGRESS FACILITIES: Fair. Three open stairways, two of which are of wood construction, of adequate width, but if two were blocked by smoke or fire, remaining stairway would prove inadequate.

COMMON HAZARDS: LIGHT -- Electric, with standard rigid conduit installation. Some oversize fuses. HEAT -- Steam boilers located in non-fireproof basement room with non-standard doors on openings to corridor. VENTILATION -- Metal ventilating flues exhaust through roof.

SPECIAL HAZARDS: Cooking for teachers and community gatherings on gas range in basement, safe.

EXPOSURES: None.

FIRST AID PROTECTION: Inadequate. Two one quart and one 2½ gallon extinguishers in basement and one one quart and two 2½ gallon extinguishers on first and second floors, approved type.

PUBLIC PROTECTION: Full city protection; three well supplied triple hydrants available; three-fourths mile to fire station over paved streets; fire alarm box on corner.

RECOMMENDATIONS

1. Install sufficient number of fire extinguishers.
2. Replace wood joisted floor over boiler room with fireproof floor and protect all openings in this room with approved automatic fire doors.
3. Provide safe means of egress from second floor, preferably a smokeproof tower.
4. Provide hand rails on all stairs not so equipped at present time.
5. Replace all oversize fuses on branch lighting circuits with fuses of not over 10 ampere capacity.

WEBSTER SCHOOL

MINNEAPOLIS, MINNESOTA

SCALE: 1 IN. = 50 FT.

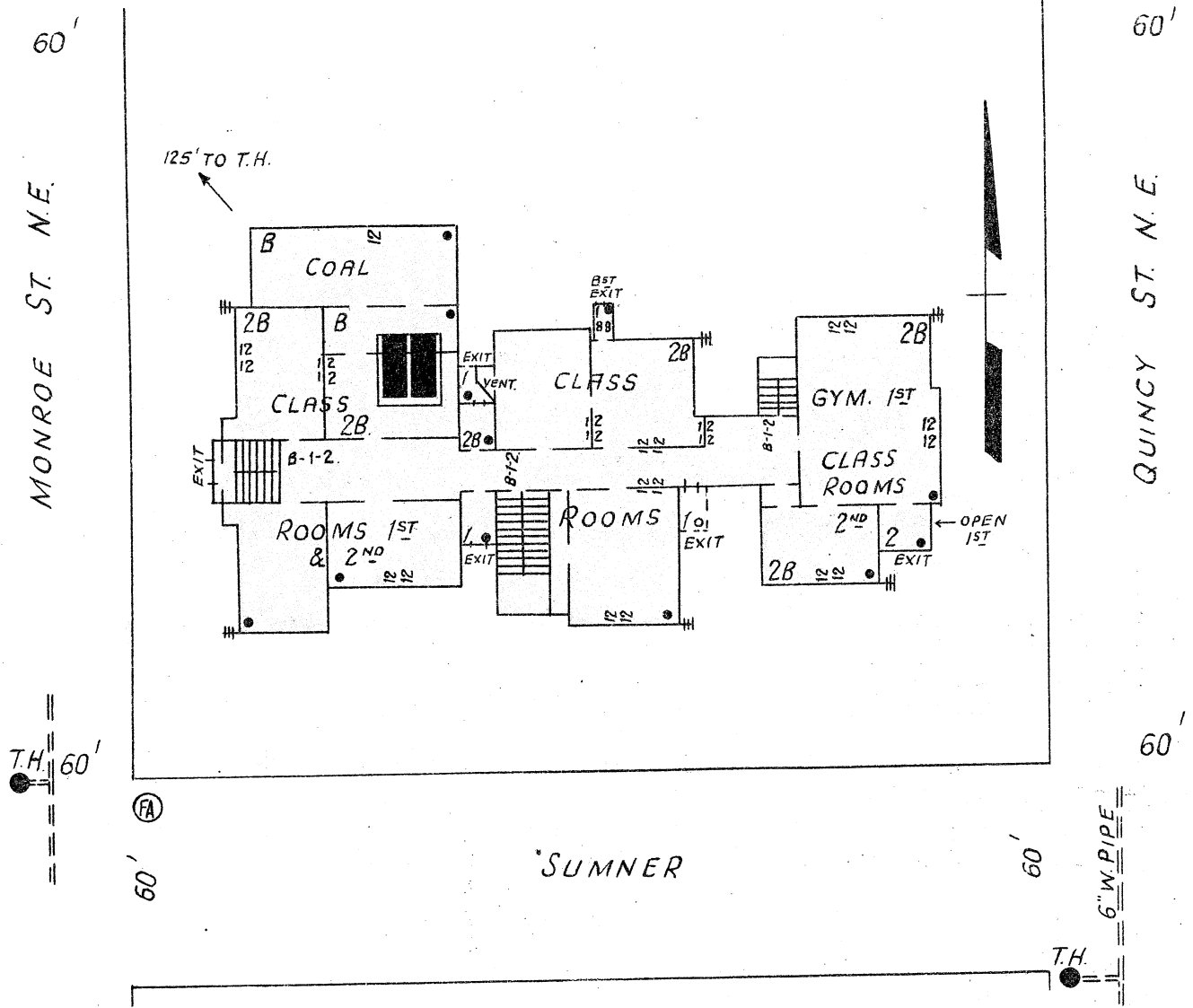

ERECTED: 1880, 1888 and 1908.
CONDITION: Good to fair.
HEIGHT: One and two stories.
AREA: Basement, 15,700 Sq. Ft., 1st and 2nd, 14,200 Sq. Ft.
WALLS: 16" and 12" brick.
FLOORS: Ordinary wood joisted, in school, conc. and wood over conc. in gymnasium.
ROOF: Ordinary wood joisted with composition and metal surfacing.
FLOOR OPENINGS: Three open stairways basement to second floor.

