

PRESCOTT SCHOOL

Lowry Avenue and Taylor Street N.E.

1931

Mr. W. W. Staudenmaier, Principal

Originally Erected	1884
Number of Class Rooms	19
Number of Special Rooms	3
Enrollment	726

PRESCOTT SCHOOL

Entire building of quick burning interior construction. From an egress standpoint this property presents one of the most serious situations among the city schools.

DETAILED REPORT

OCCUPANCY: Manual training, domestic science and sewing rooms are located in the basement; remainder of building contains only ordinary class rooms.

CARE AND MAINTENANCE: Building in fair repair and fairly well maintained.

EGRESS FACILITIES: Very poor. Two open stairways extend from basement to second floor creating a strong upward draft which would spread fire very rapidly and even though both stairways were not blocked the usable stairway would be inadequate. First floor doors deficient in width and inadequate in number. Only one door from new gymnasium would prove inadequate during community gatherings.

COMMON HAZARDS: LIGHT -- Electric, with standard rigid conduit installation. Some oversize fuses. HEAT -- Steam boilers are located in fireproof basement room with non-standard door on opening to hallway. VENTILATION -- Metal ventilating ducts exhaust above roof.

SPECIAL HAZARDS: Manual training and painting hazards well safeguarded. Heat devices in domestic science and sewing rooms properly arranged and safeguarded.

EXPOSURES: None.

FIRST AID PROTECTION: One 2½ gallon, one 5 gallon pump and two 1 quart extinguishers in basement; one 2½ gallon and two 1 quart extinguishers on each of first and second floors, approved type.

PUBLIC PROTECTION: Full city protection. Four well supplied triple hydrants available. 2½ blocks over paved streets to fire station; 2½ blocks to fire alarm box.

RECOMMENDATIONS

1. Install sufficient chemical fire extinguishers.
2. Install approved fire wall door on opening to boiler room.
3. Replace oversize fuses on branch lighting circuits with those of not over 10 ampere capacity.
4. Opening to roof space should be protected by metal covered hinged trap.
5. Provide two safe means of egress from second floor, preferably smokeproof towers.
6. Provide two additional means of egress from the first floor.
7. Provide one additional exit from gymnasium, to be not less than 90 inches in width or two additional exits with a combined width of not less than 90 inches.

PRESCOTT SCHOOL

MINNEAPOLIS, MINNESOTA

SCALE: 1 IN. = 50 FT.

← 2½ BLKS. TO (FA)

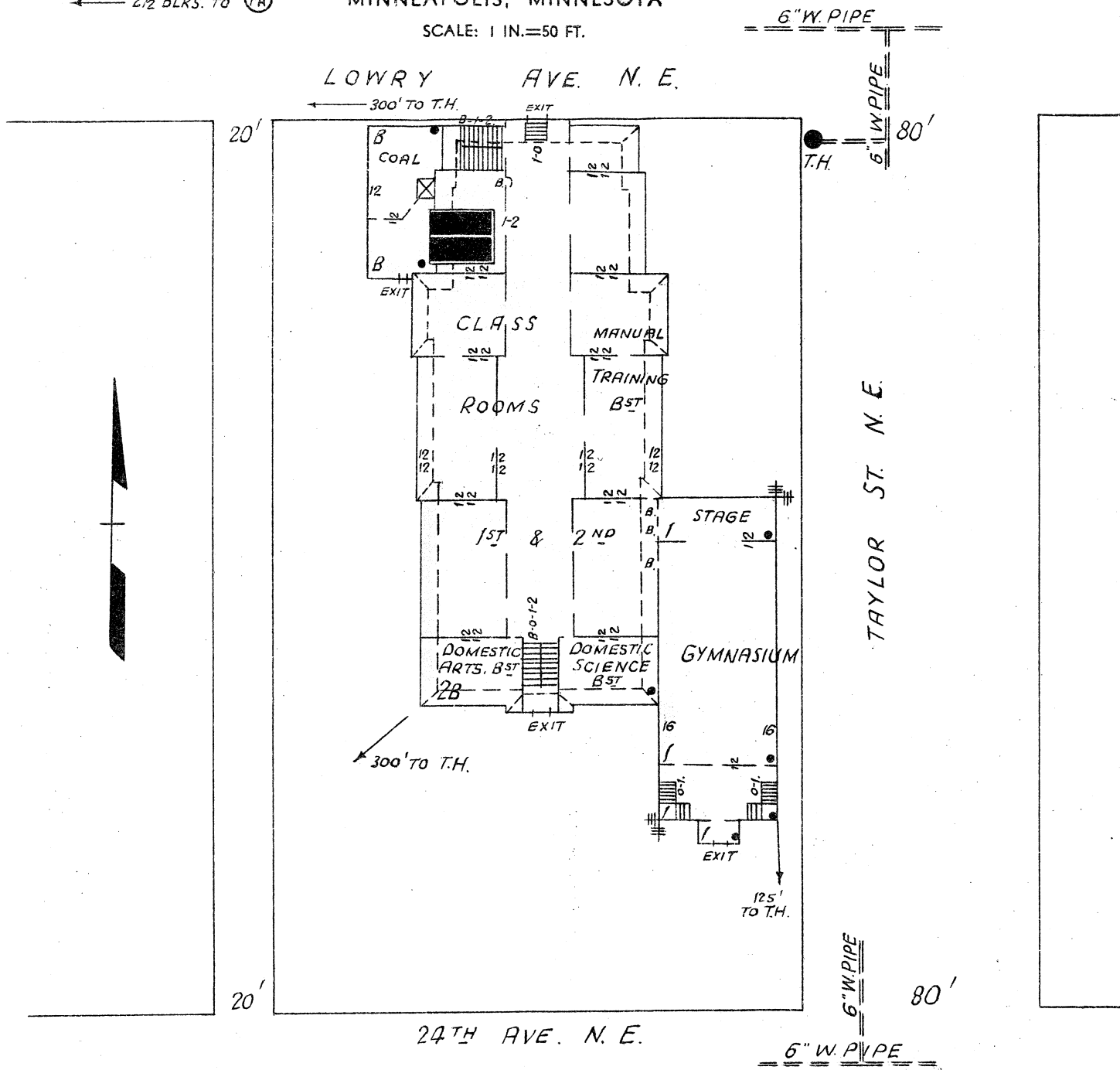

ERECTED	1884, 1901, 1909 and 1930.
CONDITION	Good.
HEIGHT	One and two stories.
AREA	Basement, 16,350 Sq. Ft. First, 19,600 Sq. Ft. Second 15,200 Sq. Ft.
WALLS	16" and 12" brick.
FLOORS	Ordinary wood joisted.
ROOF	Ordinary wood joisted with composition surfacing.
FLOOR OPENINGS	Two open stairways from basement to second floor.

