

MANN SCHOOL

Chicago Avenue and E. 34th Street

1931

Miss Matilda K. Walton, Principal

Originally Erected	1886
Number of Class Rooms	18
Number of Special Rooms	0
Enrollment	582

MANN SCHOOL

The old section is a 2½ and 3 story building with quick burning wood interior and open stairways. The third floor of this section is vacant except for a book room. Plaster has fallen off from walls and ceilings in several places. Storage of oils, desks etc., permitted under combustible stairs. New addition has concrete floors and is in good condition.

DETAILED REPORT

OCCUPANCY: This building contains no special occupancy features. Third floor not used for class rooms.

CARE AND MAINTENANCE: The new addition is in good repair, the old section in fair repair except that plaster has fallen off walls and ceilings in several places. Maintenance is good throughout.

EGRESS FACILITIES: Poor. Three open stairways basement to first and two second to first floors, open into common hallway which is subject to damage by one fire. The gymnasium-auditorium with a capacity of 285 is in the basement and has direct exit to outside in addition to exits into corridor. All exit doors open outward are equipped with panic bars and astragal strips. Iron fire escape on west side of building is not wide enough to permit more than a single file. The entrance to this escape is from narrow windows 2 feet, 8 inches above the floor level and the bottom of the escape is about 6 feet above the ground. Nearly directly under this escape is an open area to the basement which would no doubt furnish an extra danger in time of panic.

COMMON HAZARDS: LIGHT -- Electric wiring in metal conduit, well maintained, standard fuses. HEAT -- Two high pressure boilers in fireproof room with non-standard communications into coal and fan rooms. VENTILATION -- Metal ducts carried through roof.

SPECIAL HAZARDS: PAINTING -- Small amount of brush painting on first floor, paints stored in wood cabinet. COOKING -- Gas range, standard ventilation, solid gas connection.

EXPOSURES: None.

FIRST AID PROTECTION: Inadequate, there being one 2½ gallon and one 1 quart approved extinguisher on third floor, two 2½ gallon and one 1 quart approved extinguisher on second, first and in basement. Hand bell alarm.

PUBLIC PROTECTION: Adequate fire hydrants nearby and fire station one block away over paved street. Public fire alarm across street.

RECOMMENDATIONS

1. Provide sufficient installation of chemical fire extinguishers.
2. Entirely remove third story.
3. Remove tile and wood ceiling in room in front of boilers and extend concrete ceiling in this part.
4. If recommendation No. 3 is complied with install approved fire wall doors on opening into boiler room and on opening between coal room and room in front of boilers.
5. Change present heating system from high to low pressure.
6. Replace present bell alarm with electric system of alarm.
7. Remove all astragal strips from exit doors.
8. Provide metal cabinet for all paints, varnishes, etc.
9. Discontinue all storage from under stairways.
10. Repair broken plaster.
11. Enclose stairways with incombustible materials and protect openings with fire-resistive doors.

MANN SCHOOL

MINNEAPOLIS, MINNESOTA

SCALE: 1 IN. = 50 FT.

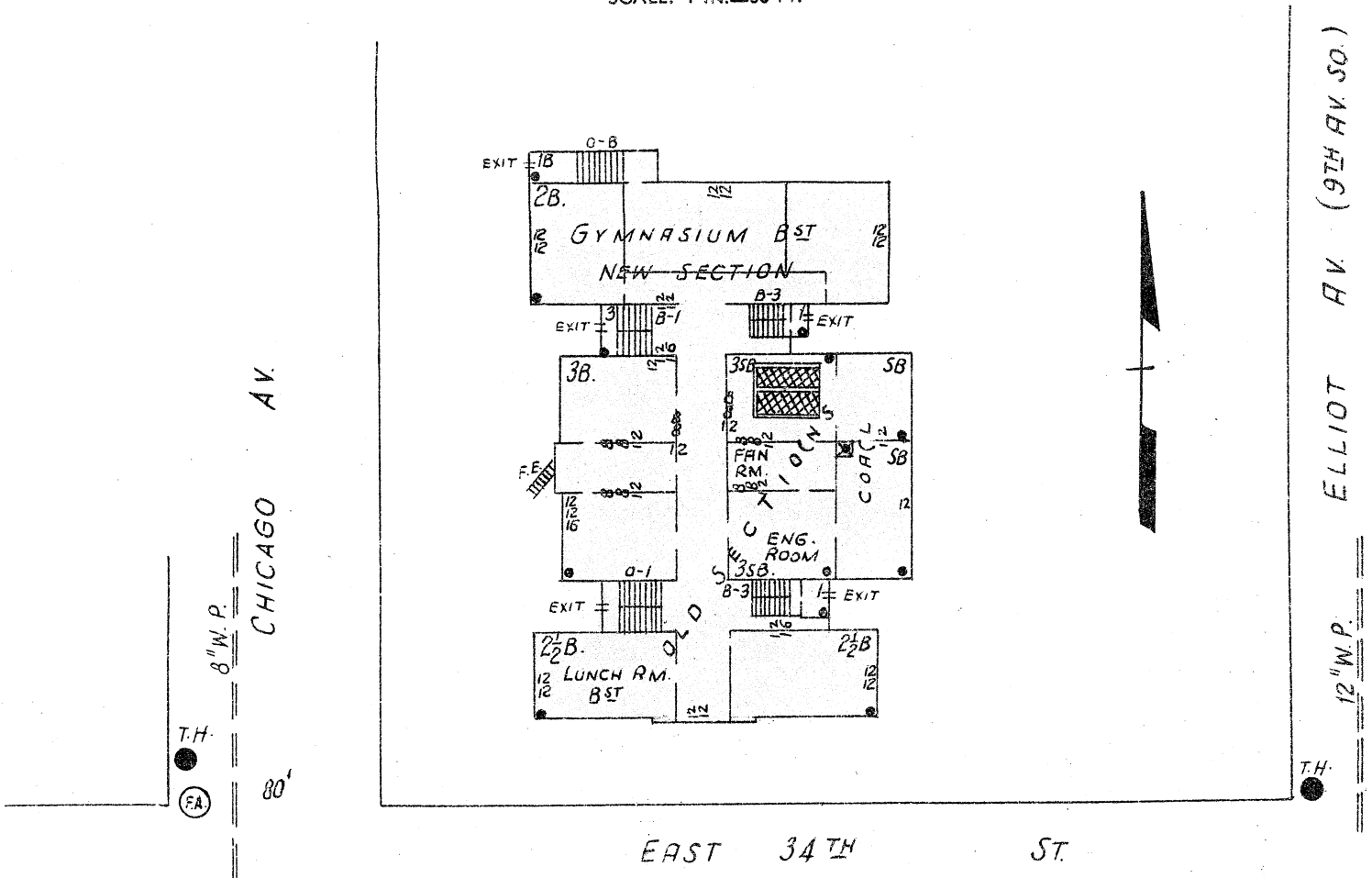

ERECTED	1886, 1905, 1916
CONDITION	Fair
HEIGHT	One, two, two and one half and three stories
AREA	Sub-basement, 2,200 Sq. Ft.; basement, first & second 12,820 on each floor. Third, 5,200 Sq. Ft.
WALLS	12" and 16" brick
FLOORS	Ordinary wood on wood supports in old section, concrete in new addition
ROOF	Ordinary wood, composition and slate covered
FLOOR OPENINGS	Three open stairways, basement to first. Two open stairways first to third

