

LAKE HARRIET SCHOOL

Sheridan Avenue S. and W. 42nd Street

1931

Miss Zada A. White, Principal

Originally Erected	1906
Number of Class Rooms	13
Number of Special Rooms	2
Enrollment	534

## LAKE HARRIET SCHOOL

A one and two story school building with quick burning interior. Egress facilities are fair.

### DETAILED REPORT

OCCUPANCY: No special features except manual training and domestic science rooms in basement.

CARE AND MAINTENANCE: Building in good repair, well maintained.

EGRESS FACILITIES: Means of egress from this building are fair. All stairways are open and all of wood construction except one which is metal. Two stairways leading from second floor and three from basement. Exit doors well distributed.

COMMON HAZARDS: LIGHT -- Electric, standard conduit wiring, HEAT -- Two high pressure steam boilers located in non-fireproof room, basement, not properly cut off. VENTILATION -- Metal ventilating ducts exhaust outside building.

SPECIAL HAZARDS: Hand work only with a small amount of painting and finishing in manual training room. Hazard is slight. Gas heated devices in domestic science room, safely installed. One electric iron protected by pilot light for sewing class.

EXPOSURES: None.

FIRST AID PROTECTION: Poor. Distribution of approved fire extinguishers is insufficient.

PUBLIC PROTECTION: Good. Three nearby hydrants. Fire alarm box one block. Fire station is two blocks from school.

### RECOMMENDATIONS

1. Replace combustible floor above boiler room with fireproof floor and provide standard firewall doors on openings to corridor and to fan room.
2. Provide an adequate number of approved fire extinguishers.
3. Protect openings to roof space with hinged metalclad traps closing in metalclad frames.
4. Provide side and intermediate hand rails on stair which leads from first floor to outside in southeast corner of building.
5. Eliminate all combustible storage beneath wood stairs in southeast corner of basement.

# LAKE HARRIET SCHOOL

MINNEAPOLIS, MINNESOTA

SCALE: 1 IN. = 50 FT.

W. 42<sup>ND</sup> ST.

D.H.

D.H.

60'

60'

80'

UPTON AV. S.

SHERIDAN AV. S.

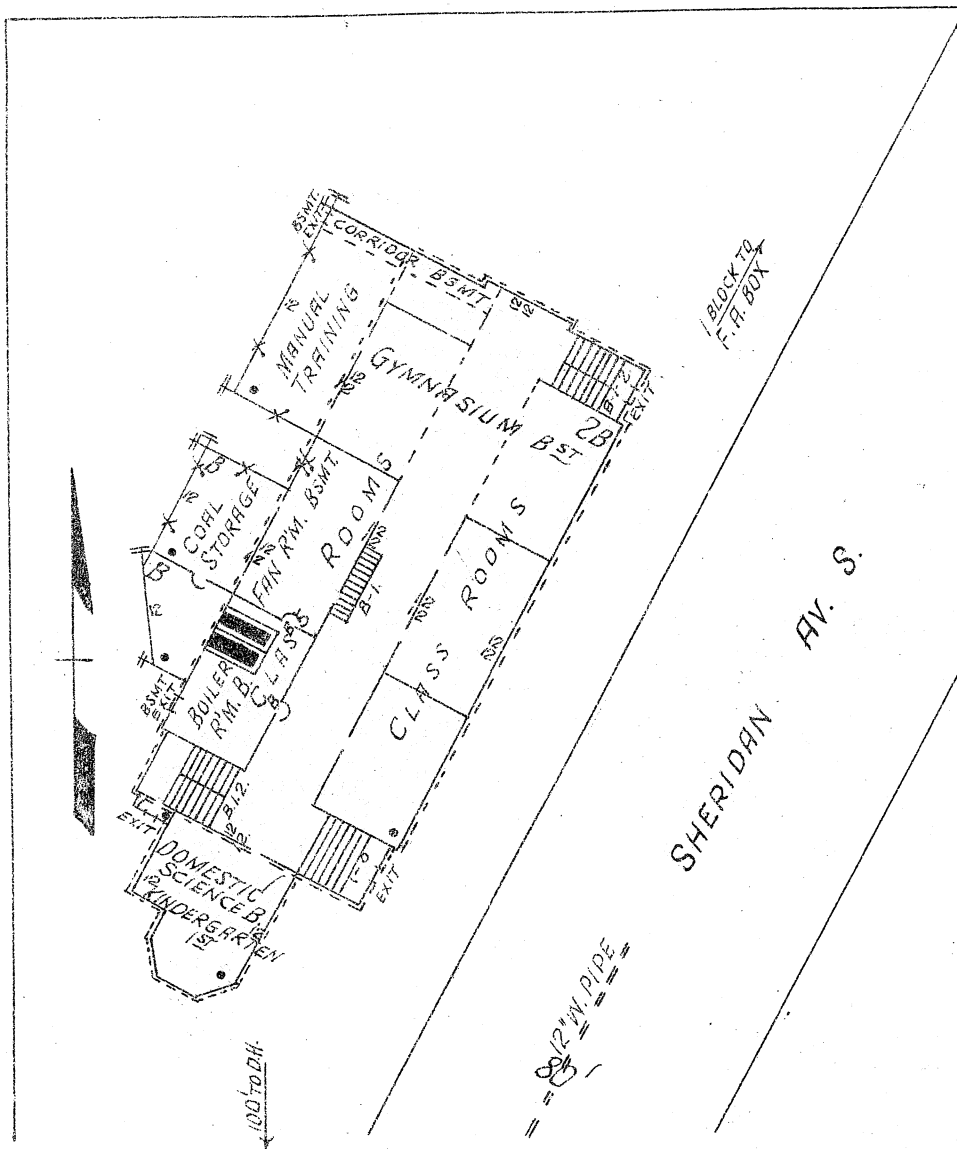

**ERECTED:** 1906, 1908, 1911.  
**CONDITION:** Good.  
**HEIGHT:** One and two stories.  
**AREA:** Bsm't., 14,216 Sq. Ft., 1st, 11,936 Sq. Ft.,  
 2nd, 10,744 Sq. Ft.  
**WALLS:** 12" brick.  
**FLOORS:** Ordinary wood joisted.  
**ROOF:** Ordinary wood joisted, composition surfacing.  
**FLOOR OPENINGS:** Three open stairways basement to 1st,  
 two open stairways 1st to 2nd.

