

HOLMES SCHOOL

5th Street and 3rd Avenue S. E.

1931

Miss Jessie E. Taylor, Principal

Originally Erected	1890
Number of Class Rooms	16
Number of Special Rooms	1
Enrollment	425

HOLMES SCHOOL

One of the older structures of entirely quick burning interior construction. Open stairways, both of which are subject to blocking, present a serious life hazard.

DETAILED REPORT

OCCUPANCY: Manual training room located in basement, remainder of building contains only ordinary class rooms.

CARE AND MAINTENANCE: Building in fair repair and housekeeping is good.

EGRESS FACILITIES: Two open stairways of wood construction would prove inadequate in the event of blocking of either by smoke or fire. Egress facilities as a whole class as poor.

COMMON HAZARDS: LIGHT -- Electric, with standard rigid conduit installation. Some oversize fuses. HEAT -- Steam boilers are located in non-fireproof basement room. VENTILATION -- Through windows. Old system of metal piping exhausts through roof.

SPECIAL HAZARDS: Gas range in community kitchen, safe. Manual training hazards well safeguarded.

EXPOSURES: None.

FIRST AID PROTECTION: Inadequate. One 2½ gallon extinguisher on each floor and one 1 quart extinguisher in basement, approved type.

PUBLIC PROTECTION: Full city protection; four well supplied triple hydrants; fire station one block over paved street. One block to fire alarm box.

RECOMMENDATIONS

1. Install sufficient chemical fire extinguishers.
2. Replace wood joisted floor over boiler room with fireproof floor and protect all openings to boiler room with approved automatic fire doors.
3. Replace oversize fuses on branch lighting circuits with those of not over 10 ampere capacity.
4. Remove phonograph and record cabinet from first floor exit hallway.
5. Provide safe means of egress from second floor on south side of building, preferably a smoke proof tower.
6. Provide hand rails on both sides of both stairs.

HOLMES SCHOOL

MINNEAPOLIS, MINNESOTA

SCALE: 1 IN. = 50 FT.

5TH ST. S.E.

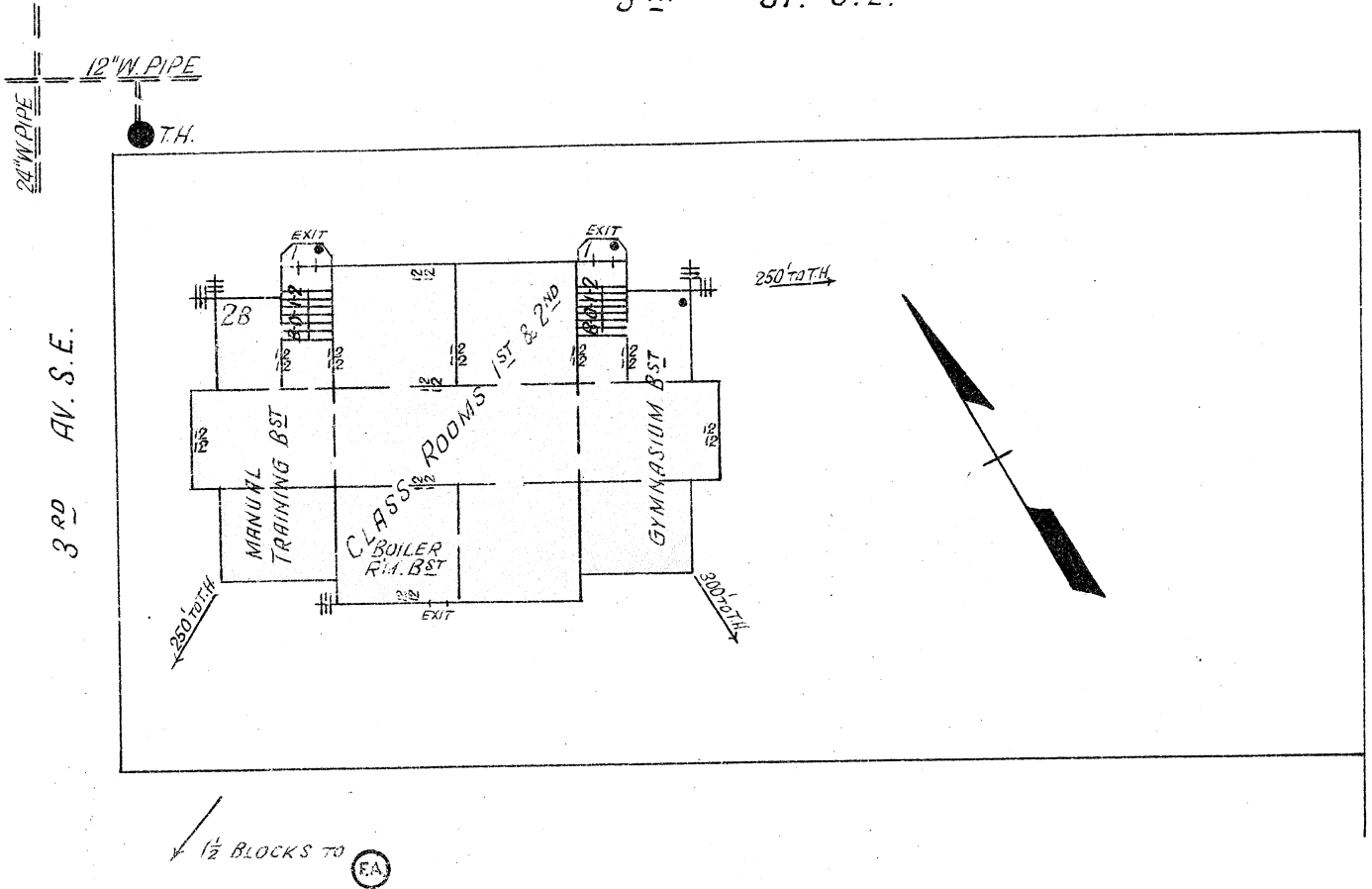

ERECTED	1890.
CONDITION	Fair.
HEIGHT	Two stories.
AREA	10,360 Sq. Ft. on each floor.
WALLS	12" brick.
FLOORS	Ordinary wood joisted.
ROOF	Ordinary wood joisted with composition surfacing.
FLOOR OPENINGS	Two open stairways from basement to second floor.

