

GREELEY SCHOOL

12th Avenue S. and E. 26th Street

1931

Miss Beulah H. Wallar, Principal

Originally Erected	1888
Number of Class Rooms	14
Number of Special Rooms	0
Enrollment	570

GREELEY SCHOOL

One of the older school buildings of the city with quick burning wood interior construction. Open metal stairways are as well located as possible in so far as the old section is concerned but new section with no stairway is cut off from the old section by metal fire curtains creating an entirely unnecessary hazard.

DETAILED REPORT

OCCUPANCY: Sub-normal manual training room, auditorium and gymnasium, teachers and students lunch room, boiler room in basement; ordinary class rooms above.

CARE AND MAINTENANCE: Painters were at work washing the walls at time of inspection but except for the disorder due to this work being done building was in good condition in so far as maintenance was concerned.

EGRESS FACILITIES: Fair. Two metal stairways at opposite ends of old section of building. No stairways in new section which is separated from old section by metal roller curtain. This curtain is of no value and should be removed as in case this dropped before the new section was entirely evacuated the only possible means of escape would be through high windows. The kindergarten is located on the first floor of this section some 10 feet above the ground.

COMMON HAZARDS: LIGHT -- Electric, standard conduit wiring. Some oversized fuses. HEAT -- High pressure boiler in separate room in basement with tile ceiling supported from wood joists above. VENTILATION -- Metal and wood metal lined ducts extend through roof.

SPECIAL HAZARDS: None except woodworking in sub-normal class room and small amount of painting in kindergarten.

EXPOSURES: None.

FIRST AID PROTECTION: Inadequate number of approved extinguishers distributed on all floors.

PUBLIC PROTECTION: Full city fire protection with three easily available hydrants on well supplied mains. Fire alarm box, one block. Fire department station, one half mile with paved streets intervening.

RECOMMENDATIONS

1. Immediately remove fire curtains on both first and second floors separating new section from old. In case of fire these curtains could block egress from the new section and too great dependence should not be placed upon the fastening of the chain.
2. If No. 1 is not complied with, provide a safe means of egress from new section of building, preferably a smokeproof tower leading direct to outside.
3. Provide standard fire extinguisher distribution throughout.
4. Replace all oversized fuses on branch lighting circuits with those of not more than 15 ampere capacity.
5. Provide metal cabinets for paint in kindergarten room.
6. Install concrete ceiling over boiler room and equip openings to boiler room with door approved for protecting openings in fire walls.
7. Fill up opening around pipes in storeroom No. 3 where they pass through ceiling into attic; also provide additional insulation for these pipes in this storeroom and storeroom No. 2 so heat in these small rooms will not be excessive.

GREELEY SCHOOL

MINNEAPOLIS, MINNESOTA

SCALE: 1 IN. = 50 FT.

T.H.

T.H.

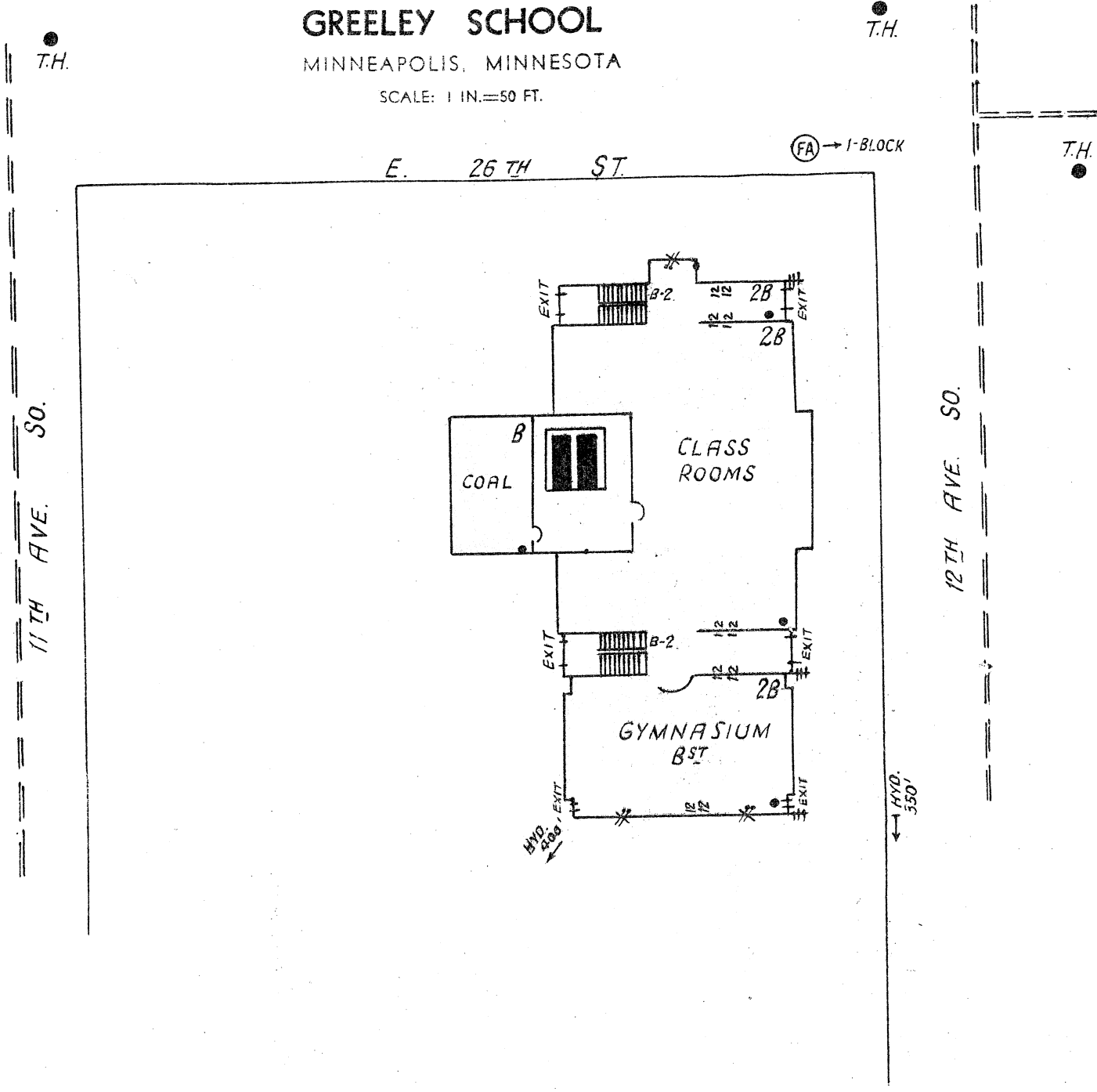

ERECTED: 1888 and 1912.
CONDITION: Fair.
HEIGHT: One and two stories.
AREA: Basement, 15,340 Sq. Ft., 1st and 2nd floors, 14,080 Sq. Ft. each.
WALLS: 12" brick.
FLOORS: Ordinary wood joisted.
ROOF: Wood joisted, composition surfaced.
FLOOR OPENINGS: Two open stairways, basement to 2nd. One, 2nd to attic.

