

CLINTON SCHOOL

Clinton Avenue and E. 28th Street

1931

Miss Nellie M. Fields, Principal

Originally Erected	1889
Number of Class Rooms	16
Number of Special Rooms	0
Enrollment	653

CLINTON SCHOOL

Original building is among the older schools with quick burning wood interior. Later addition is fireproof.

DETAILED REPORT

OCCUPANCY: Standard motion picture booth with approved slide machine in gymnasium, usual class rooms.

CARE AND MAINTENANCE: Building in good repair and well maintained.

EGRESS FACILITIES: Fair, open concrete stairways, well located.

Exit lights and panic bars provided where needed.

COMMON HAZARDS: LIGHT -- Electric lights with wiring in metal conduit. HEAT -- Two asbestos encased low pressure steam boilers, good clearance, combustible ceiling, tile lined. VENTILATION -- Metal ventilating flues are carried through roof.

SPECIAL HAZARDS: Gas plates for cooking teachers lunches and in community kitchen. PAINTING -- Small amount of brush work in kindergarten and sub-normal department. Paints in kindergarten stored on wood shelves. Metal cabinet has been provided for sub-normal department but paints were found stored on table.

EXPOSURES: None.

FIRST AID PROTECTION: Inadequate supply of chemical fire extinguishers, there being three extinguishers on each floor. Electric alarm.

PUBLIC PROTECTION: Full city protection; adequate hydrants nearby; station six blocks from school over paved streets; fire alarm box two blocks away.

RECOMMENDATIONS

1. Install sufficient chemical extinguishers.
2. Provide concrete slab ceiling over boiler room.
3. If No. 2 is complied with, install approved three ply fire doors on openings into boiler room and brick up all unnecessary openings.
4. Install hinged wood trap on opening to roof space.
5. All paints etc. should be stored in metal cabinets.

CLINTON SCHOOL

MINNEAPOLIS, MINNESOTA

SCALE: 1 IN. = 50 FT.

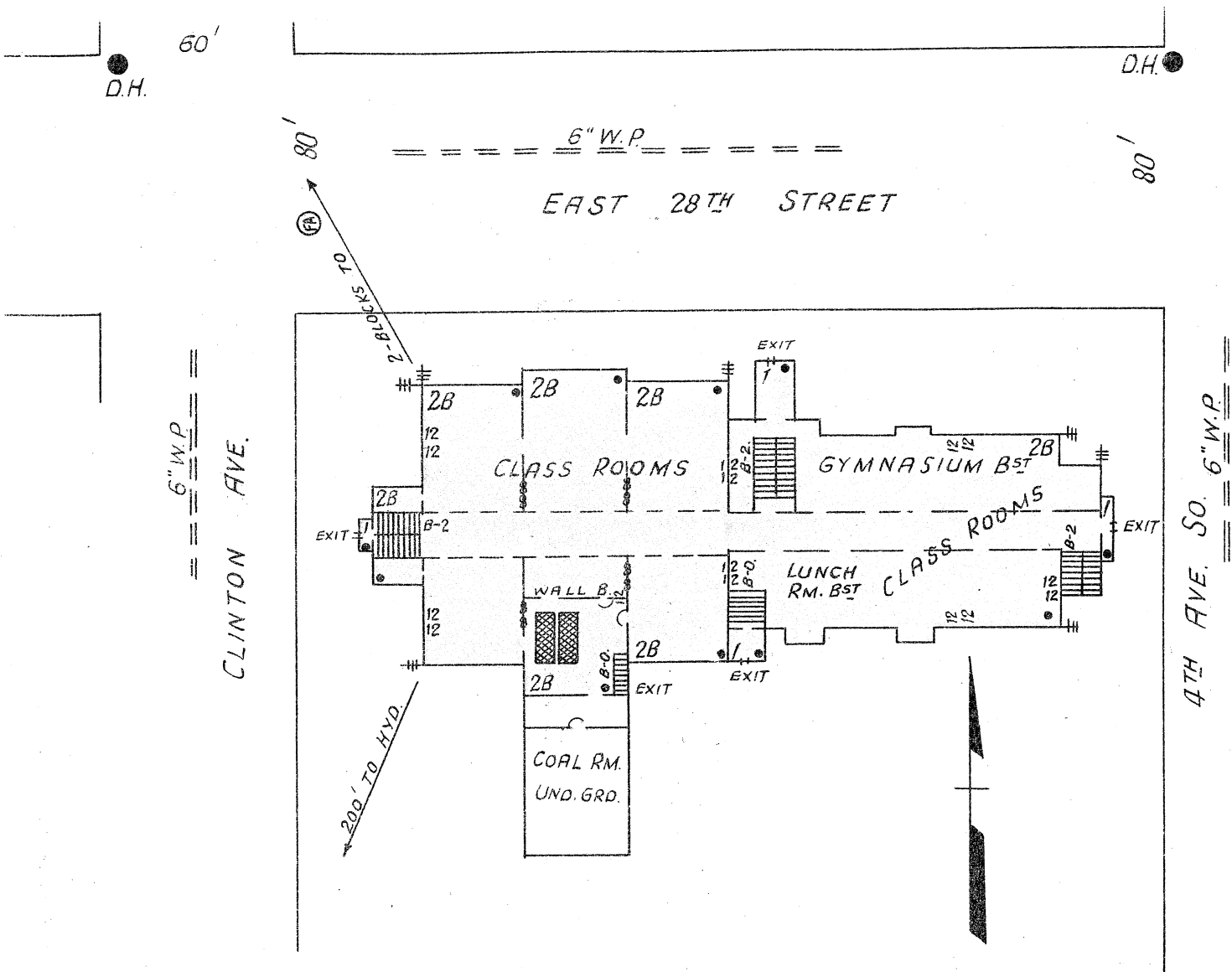

ERECTED 1889, 1920, 1921.
CONDITION Good.
HEIGHT: One and two stories.
AREA: Bsmt., 14,500 Sq. Ft., 1st Flr., 16,400 Sq. Ft., 2nd Flr., 15,700 Sq. Ft.
WALLS: 12" brick and hollow tile faced with 4" brick.
FLOORS: Ordinary wood in old section, concrete in new.
ROOF: Ordinary wood, composition surfaced. Concrete ceiling below in new part.
FLOOR OPENINGS: Three open stairways bst. to 2nd floor.

