

AGASSIZ SCHOOL

Harriet Avenue and W. 38th Street

1931

Miss Grace B. Sherwood, Principal

Originally Erected	1922
Number of Class Rooms	10
Number of Special Rooms	0
Enrollment	425

AGASSIZ SCHOOL

A one and two story modern school building of fireproof construction with open stairways. Egress facilities good.

DETAILED REPORT

OCCUPANCY: Building contains no special features.

CARE AND MAINTENANCE: Building comparatively new and maintenance excellent.

EGRESS FACILITIES: Egress facilities from this building are good. Open stairways to second floor. No difficulty should be experienced in evacuating auditorium with ease and rapidity.

COMMON HAZARDS: LIGHT -- Electric lights, standard conduit wiring.

HEAT -- Two low pressure steam boilers in fireproof room in basement with non-standard cut offs. VENTILATION -- Metal ventilating ducts exhaust into combustible foul air chamber in roof space.

Air is then recirculated to basement or exhausted through roof.

SPECIAL HAZARDS: Coffee making in teachers lunch room and community kitchen on gas range, safely installed.

FIRST AID PROTECTION: Inadequate supply of chemical fire extinguishers, none in basement, two on first and second floors.

PUBLIC PROTECTION: School is under full city fire protection. Two fire hydrants nearby and two additional within 500 feet. Public fire alarm box 100 feet. Nearest fire station one mile distant over paved streets.

RECOMMENDATIONS

1. Provide standard fire wall doors on opening from boiler room to corridor.
2. Install chemical fire extinguishers in adequate number.
3. Protect all openings to roof space of main building and of auditorium with standard fire doors.
4. Replace thin non-standard lamp cord in teachers rest room with standard rubber covered cord.
5. Repair shutters on projection openings in movie booth to make them automatic closing.
6. Repair fire door on movie booth so that it will close tightly.
7. Entirely line combustible foul air chamber in roof space with a continuous metal duct.

AGASSIZ SCHOOL

MINNEAPOLIS, MINNESOTA

SCALE: 1 IN. = 50 FT.

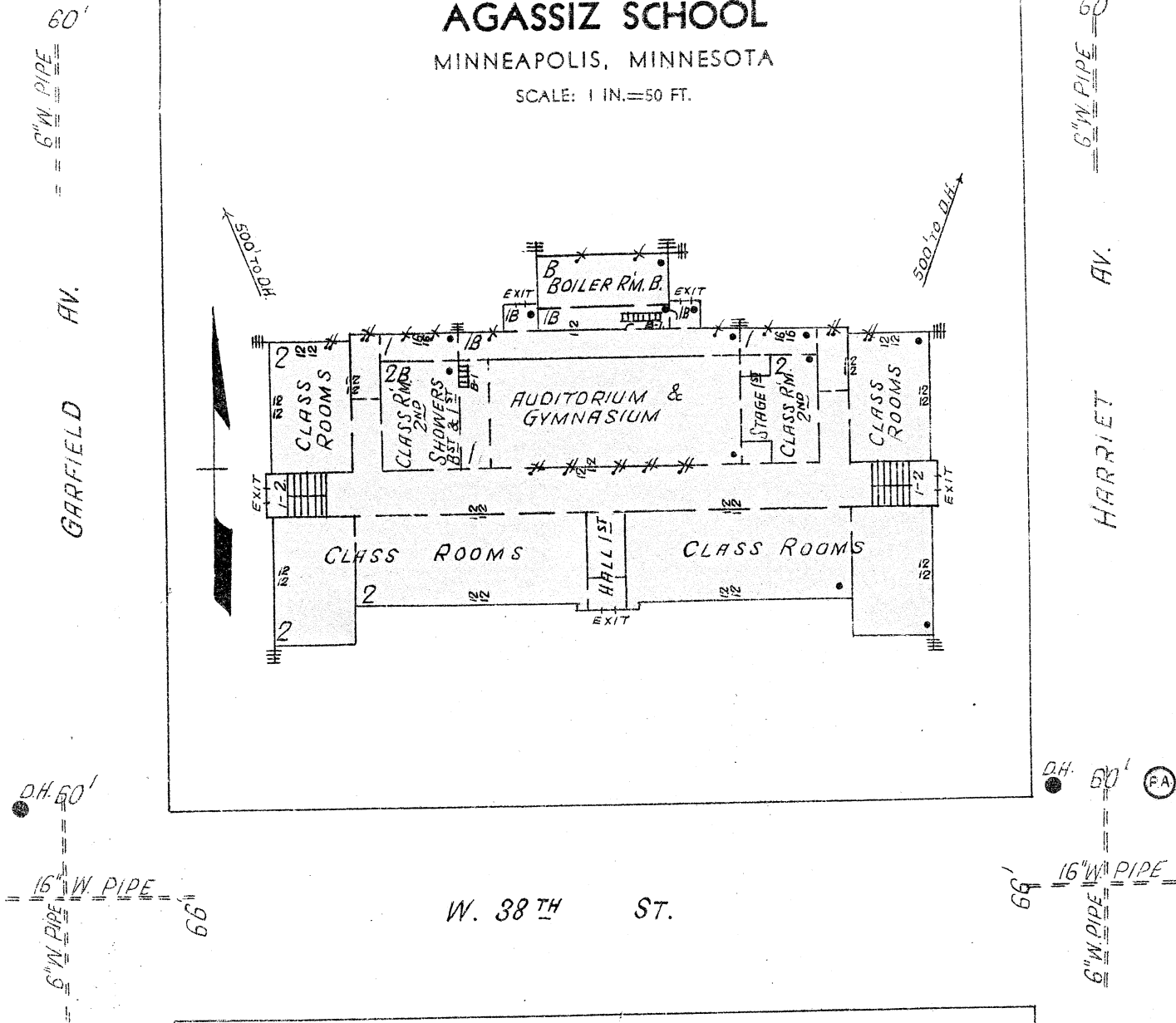

W. 38TH ST.

<p>ERECTED 1922.</p> <p>CONDITION Excellent.</p> <p>HEIGHT One and two stories.</p> <p>AREA Bsmt., 2,888 sq. ft.; 1st, 18,773 sq. ft.; 2nd, 13,311 sq. ft.</p> <p>WALLS 12 and 16 in. brick and tile; panel walls in reinforced concrete frame.</p> <p>FLOORS Reinforced concrete slab.</p> <p>ROOF False wood roof, concrete slab ceiling beneath.</p> <p>FLOOR OPENINGS Two enclosed stairways basement to 1st, two open stairways 1st to 2nd.</p>	<p>1922.</p> <p>Excellent.</p> <p>One and two stories.</p> <p>Bsmt., 2,888 sq. ft.; 1st, 18,773 sq. ft.; 2nd, 13,311 sq. ft.</p> <p>12 and 16 in. brick and tile; panel walls in reinforced concrete frame.</p> <p>Reinforced concrete slab.</p> <p>False wood roof, concrete slab ceiling beneath.</p> <p>Two enclosed stairways basement to 1st, two open stairways 1st to 2nd.</p>
--	---

