

WINDOM SCHOOL

Blaisdell Avenue S. at 58th Street W.

1931

Mr. F. E. Maxson, Principal

Originally Erected	1920
Number of Class Rooms	22
Number of Special Rooms	3
Enrollment	600

WINDOM SCHOOL

A one and two story building of semi-fireproof construction with narrow and open stairways. Egress facilities from auditorium are deficient.

DETAILED REPORT

OCCUPANCY: Small lunch room, school bus garage and auditorium in basement. Domestic science and sewing room, first floor. Manual training, second floor. Remainder of first and second floors used for ordinary class rooms.

CARE AND MAINTENANCE: Building comparatively new and very well maintained.

EGRESS FACILITIES: Egress facilities from this building class only as fair on account of unusually narrow stairways from second to first floor. Exit facilities from auditorium are 12% deficient. All stairways above first floor are not enclosed and therefore subject to blocking by smoke or fire.

COMMON HAZARDS: LIGHT -- Electric lights with wiring in rigid metal conduit. HEAT -- Steam boilers are located in fireproof addition with non-standard cut off. VENTILATION -- Metal ventilating ducts exhaust above roof level.

SPECIAL HAZARDS: Coffee making on gas range in lunch room, basement safe arrangement. MANUAL TRAINING -- Woodworking once weekly, room is cleaned at end of day. DOMESTIC SCIENCE -- Gas plates and ovens employed, standard arrangement. BUS GARAGE -- Four school buses housed in fireproof room in basement, not cut off. No repairing. AUDITORIUM -- Small stage with two sets of scenery.

FIRST AID PROTECTION: Chemical fire extinguishers are installed throughout building in sufficient number.

PUBLIC PROTECTION: Four hydrants on 6 and 12 inch dead end mains are available. Fire station one mile and one-half distant over paved streets. Fire alarm box 350 feet.

RECOMMENDATIONS

1. Provide standard cut off for boiler room.
2. Replace all oversize fuses on branch lighting circuits with those of not over 10 ampere capacity.
3. Remove astragal strips from all exit doors.

WINDOM SCHOOL

MINNEAPOLIS, MINNESOTA

SCALE: 1 IN. = 50 FT.

60'

WENTWORTH AVE. S.

350' TO D.H. END
FIRE ALARM

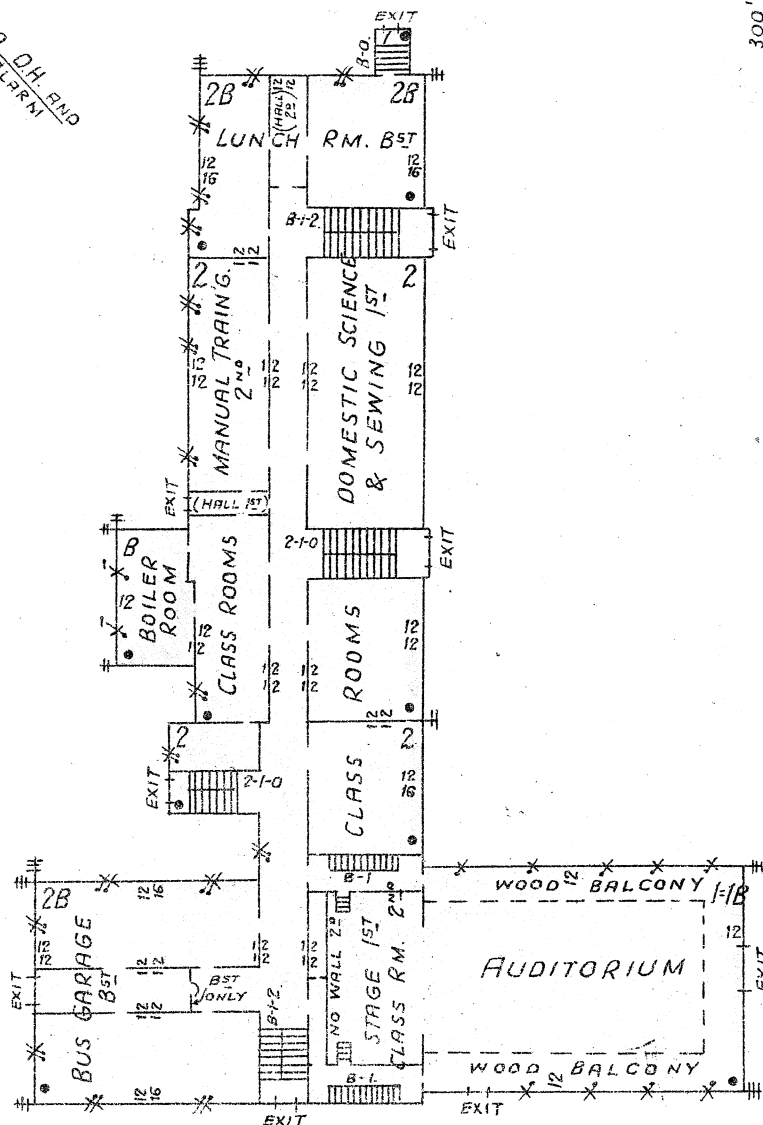

300' TO D.H.
215' TO WEST
58TH ST.

BLAISDELL AVE. S.

60'

500' TO D.H.

500' TO D.H.

60'

60'

ERECTED	1920, 1923, 1925.
CONDITION	Good.
HEIGHT	One and two stories.
AREA	Basement 11,650 Sq. Ft. First and second, 18,427 Sq. Ft.
WALLS	12" brick and 12" and 16" brick and tile.
FLOORS	Reinforced concrete, small section of second floor is ordinary wood joisted.
ROOF	Ordinary wood joisted, auditorium roof supported on steel trusses.
FLOOR OPENINGS	Four enclosed stairways, basement to first, four open stairways first to second.

