

WARRINGTON SCHOOL

Clinton Avenue and E. 37th Street

1931

Mrs. Louise H. Watson, Principal

Originally Erected	1898
Number of Class Rooms	20
Number of Special Rooms	0
Enrollment	716

WARRINGTON SCHOOL

One of the older grade schools of brick construction with quick burning wood interior and large open stairways. Communicates with the Bryant Junior High school through a 100 foot tunnel, non-standard doors.

DETAILED REPORT

OCCUPANCY: This building contains no special occupancy features.

CARE AND MAINTENANCE: Building is old but in fair repair. Maintenance good.

EGRESS FACILITIES: Poor, from annex and from the second floor of the main building. Class rooms in annex have only one door to common hallway. Two large open wood stairways in main building from second to first floors both could be totally blocked by one smoke hazard.

COMMON HAZARDS: LIGHT -- Electric lights with wiring mostly in metal conduit. Some oversize fuses. There is some very bad wiring in north rooms in the basement consisting of non-standard lamp cords used very freely. HEAT -- Both buildings are heated by steam conveyed from the Bryant Junior High. Old boiler still in place in the annex building, but boiler is never used. VENTILATION -- Metal ventilating flues are carried through the roof.

SPECIAL HAZARDS: COOKING -- Gas stove for community kitchen, safe. PAINTING -- Small amount of brush work in main building, paints stored in wood cabinet.

EXPOSURES: Annex and main building expose each other at 22 feet. Annex exposed by fireproof Bryant Junior High at 35 feet and main building exposed at 82 feet by same High school.

FIRST AID PROTECTION: Inadequate number of chemical extinguishers, there being one on each floor and in the basement in the main building and two on the first floor and one in the basement in the annex. The extinguishers in the annex are of the one quart type. Electric alarm in main building and bell in annex.

PUBLIC PROTECTION: Full city protection, adequate number of hydrants nearby, two stations eleven blocks away over paved streets, fire alarm box on corner.

RECOMMENDATIONS

1. Install sufficient chemical fire extinguishers.
2. Replace cord wiring in basement with metal conduit.
3. Replace oversize fuses on branch lighting circuits with those of not over 10 ampere capacity.
4. Discontinue the storage of wood seats under stairway in basement.
5. Provide metal cabinet for all paints.
6. Provide hinge for trap opening into attic.
7. Provide one opening direct to outside from each room in annex.
8. Provide substantial gate to be kept locked on stairways to basement in annex.

WARRINGTON SCHOOL

MINNEAPOLIS, MINNESOTA

SCALE: 1 IN. = 50' FT.

ERECTED: 1898, 1903 and 1910
CONDITION: Fair
HEIGHT: Two stories
AREA: 11,850 Sq. Ft., each floor and basement
FLOORS: Ordinary wood
ROOF: Ordinary wood, slate surfaced
FLOOR: Two open stairways, basement to second floor; one open stairway, basement to first floor
OPENINGS:

PORTABLES

ANNEX

CONDITION: Fair
HEIGHT: One story
AREA: 3,950 Sq. Ft.
FLOORS: Ordinary wood
ROOF: Ordinary wood
FLOOR: Two open stairways, basement to first floor
OPENINGS:

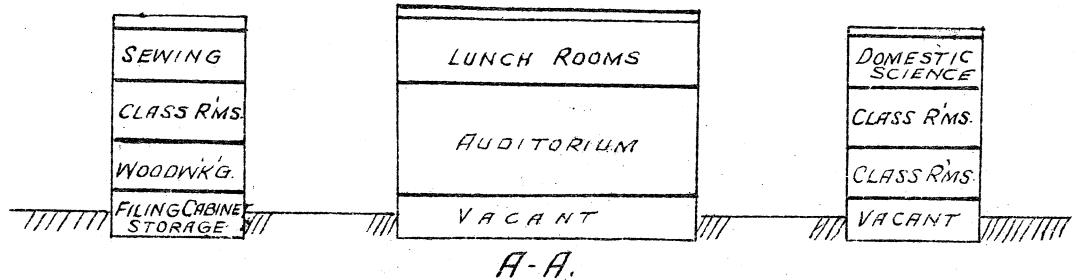

66'

TH

24" W.P.

3RD AV. S.

66'

(F.A.)

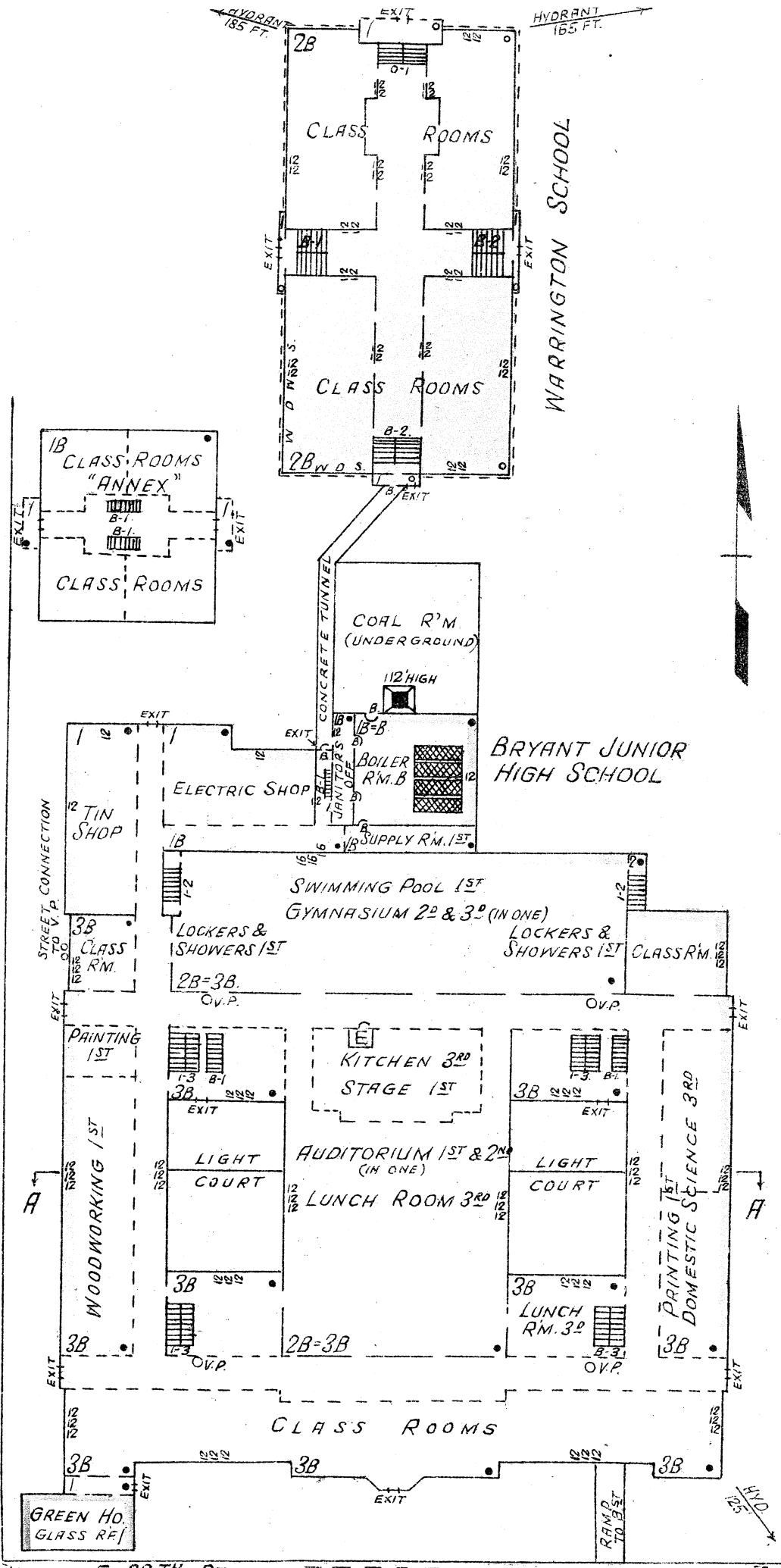

60'

CLINTON AV.

60'

60'