

TUTTLE SCHOOL

18th and Talmadge Avenues S. E.

1931

Mr. H. P. Cooper, Principal

Originally Erected	1911
Number of Class Rooms	14
Number of Special Rooms	0
Enrollment	513

## TUTTLE SCHOOL

Original building of fireproof construction with the exception of the wood roof, addition of fireproof construction with a false wood roof.

### DETAILED REPORT

OCCUPANCY: This building has no special features.

CARE AND MAINTENANCE: Building in good repair except for sagging floor in basement of original section. Housekeeping is good.

EGRESS FACILITIES: Fairly good. Three open metal stairways of adequate width.

COMMON HAZARDS: LIGHT -- Electric with standard rigid conduit installation. Some oversize fuses. Long non-standard portable cord. HEAT -- Steam boilers are located in fireproof basement room with non-standard doors on openings to corridor. VENTILATION Metal ventilating flues exhaust through roof.

SPECIAL HAZARDS: Cooking for teachers and community gatherings on gas range in basement, safe. Painting in kindergarten without metal cabinet for paints or approved waste can for oily rags.

EXPOSURES: None.

FIRST AID PROTECTION: Inadequate. Two one quart and two 2½ gallon extinguishers in basement and on first floor, three one quart and one 2½ gallon extinguishers on second floor, all approved type.

PUBLIC PROTECTION: Full city protection; four well supplied double hydrants available. Three-fourths mile to fire station over paved streets; two and one-half blocks to fire alarm box.

### RECOMMENDATIONS

1. Install sufficient number of fire extinguishers.
2. Provide approved automatic fire wall doors on openings to boiler room from corridor.
3. Replace oversize fuses on branch lighting circuits with fuses of not over 15 ampere capacity.
4. Non-standard cord in library should be replaced by a permanent lighting fixture.
5. Opening to roof space in original section should be protected by a hinged metal covered trap.
6. All exit lights in auditorium should be kept in working order.
7. Provide metal cabinet for flammable paints in kindergarten.
8. Provide approved metal waste can for oily rags in kindergarten.

# TUTTLE SCHOOL

MINNEAPOLIS, MINNESOTA

SCALE: 1 IN. = 50 FT.

TALMADGE AVE. S. E.

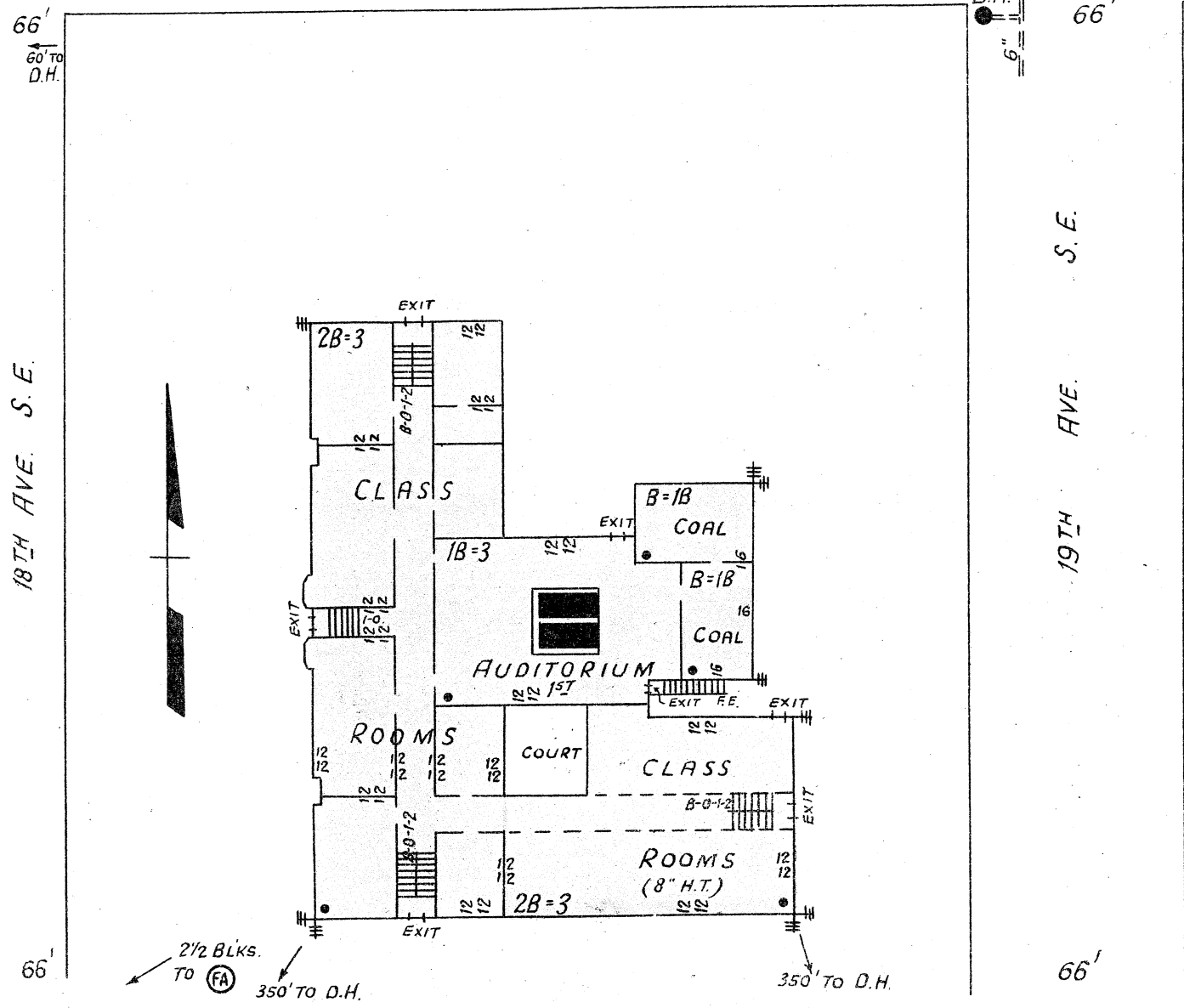

**ERECTED:** 1911 and 1926.

**CONDITION:** Good.

**HEIGHT:** One and two stories.

**AREA:** Basement, 19,100 Sq. Ft., 1st 17,400 Sq. Ft., 2nd, 13,900 Sq. Ft.

**WALLS:** 16" and 12" brick and hollow tile, brick faced.

**FLOORS:** Small part ordinary wood joisted in bsmt. of old section, remainder conc. on earth and reinf. conc. and reinf. conc. joist and tile.

**ROOF:** Ordinary wood joisted with composition surfacing. Reinf. conc. ceiling in fire-proof section.

**FLOOR OPENINGS:** Three open stairways basement to second floor.

