

TRUDEAU SCHOOL

4th Street and 9th Avenue S. E.

1931

Miss G. Benson, Principal

Originally Erected	1872
Number of Class Rooms	4
Number of Special Rooms	1
Enrollment	98

TRUDEAU SCHOOL

One of the oldest buildings with quick burning wood interior construction. Egress facilities are poor as stairways are narrow and poorly arranged. One of the rear exit doors was found locked at the time of this inspection.

DETAILED REPORT

OCCUPANCY: This building is used for the care and education of anemic and under nourished children. Three lunches and a full dinner are prepared in a kitchen located in the basement. Sleeping room, showers, dining room and one class room are located on the first floor. Three class rooms, sleeping room and nurses room located on the second floor.

CARE AND MAINTENANCE: Building in fair to poor repair due to age. Attic space considerably torn up. Housekeeping is fair.

EGRESS FACILITIES: Narrow open stairways of wood construction are so situated they could all be blocked by same fire. From an egress standpoint this risk classes as poor.

COMMON HAZARDS: LIGHT -- Electric with standard rigid conduit installation. Some oversize fuses. HEAT -- Steam boiler located in non-fireproof basement room with tile ceiling on metal tees supported from wood first floor. VENTILATION -- Through windows.

SPECIAL HAZARDS: Cooking for students on gas range safely arranged.

EXPOSURES: None.

FIRST AID PROTECTION: Inadequate. Two one quart extinguishers on each floor and one 2½ gallon extinguisher on first and second floors.

PUBLIC PROTECTION: Full city protection; four well supplied triple hydrants available; seven blocks to fire station over paved streets; 100 feet to fire alarm box.

RECOMMENDATIONS

1. Install sufficient chemical fire extinguishers.
2. Replace wood joisted floor over boiler room with fireproof floor and protect all openings to boiler room with approved automatic fire doors.
3. Completely cover door to roof space with metal and keep door locked.
4. Clean up roof space and close up unused ventilation flues.
5. Provide safe means of egress from second floor, preferably a smoke proof tower.
6. Keep all exit doors unlocked during school session.
7. Replace oversize fuses on branch lighting circuits with fuses of not over 10 ampere capacity.

TRUDEAU SCHOOL

MINNEAPOLIS, MINNESOTA

SCALE: 1 IN.=50 FT.

5TH ST. S. E.

6" W. PIPE
T.H.

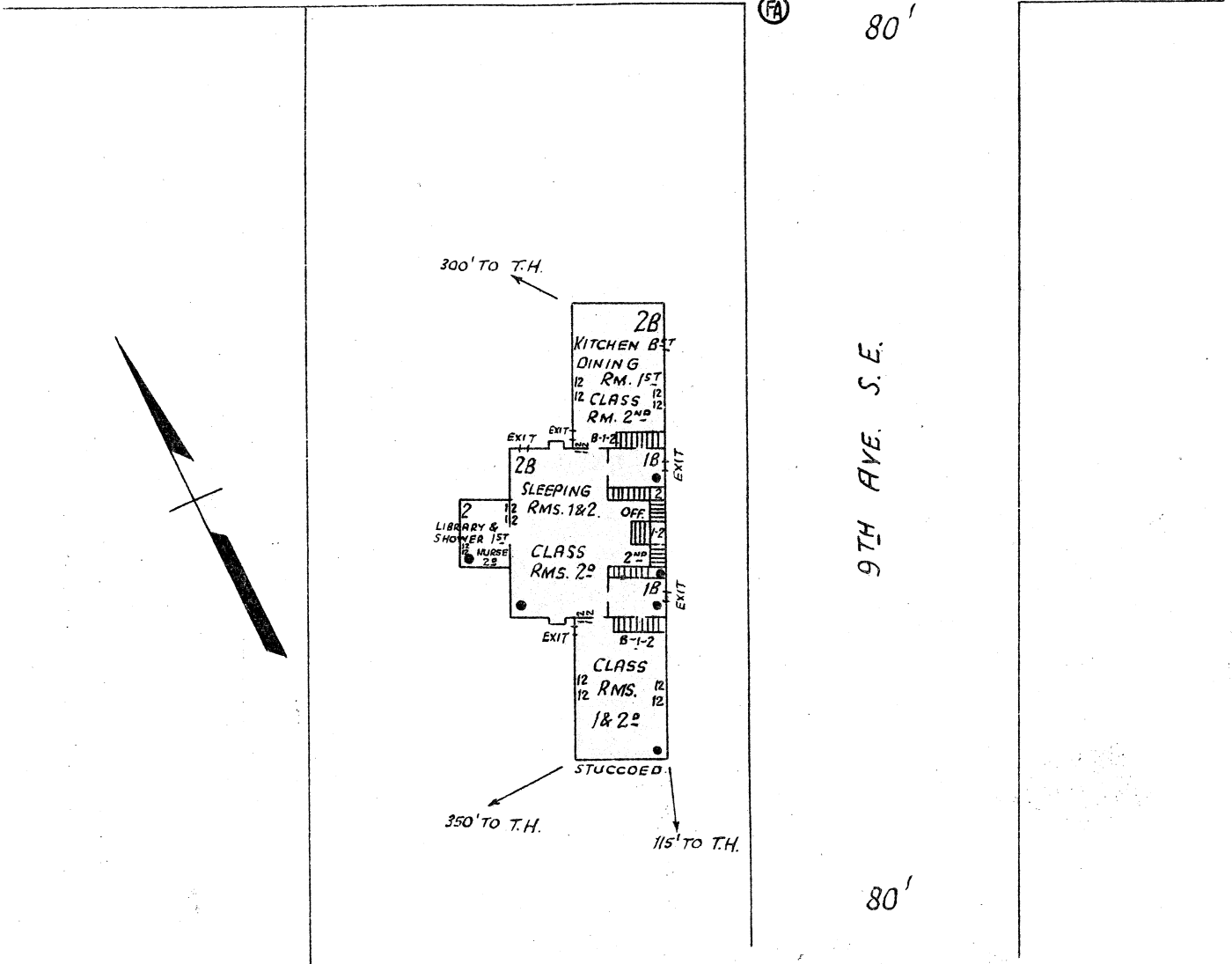

ERECTED: 1872.
CONDITION: Fair to poor.
HEIGHT: One and two stories.
AREA: Basement, 4,545 Sq. Ft.
 First, 4,845 Sq. Ft.
 Second, 4,440 Sq. Ft.
WALLS: 12" brick, stuccoed.
FLOORS: Ordinary wood joisted.
ROOF: Ordinary wood joisted, slate surfacing.
FLOOR OPENINGS: Two open stairways, basement to first and three open stairways, first to second floor.

