

SHERIDAN SCHOOL

Broadway and University Avenue N.E.

1931

*This building replaced
by new elementary-junior
high school, 1932.*

Mr. E. A. Mooney, Principal

Originally Erected	1896
Number of Class Rooms	20
Number of Special Rooms	3
Enrollment	739

SHERIDAN SCHOOL

A three story and basement building of entirely quick burning interior construction. Egress facilities are very poor and the use of the third floor hallway for assembly purposes presents a very serious life hazard.

DETAILED REPORT

OCCUPANCY: Manual training and domestic science rooms are located in the basement, sewing room located on first floor, remainder of building contains ordinary class rooms.

CARE AND MAINTENANCE: Condition, due to age, classes from good to poor, many places with plaster off on second have been patched with building paper. Housekeeping is good.

EGRESS FACILITIES: Very poor. Only two open wood stairways both of which are subject to blocking by the same fire. In the event of fire while the third floor hallway was in use for assembly a serious life loss could not be averted as the steep narrow iron fire escapes are of negligible value.

COMMON HAZARDS: LIGHT -- Electric, with standard rigid conduit installation. HEAT -- Steam boilers are located in non-fireproof basement room, safe. VENTILATION -- Metal ventilating flues exhaust through roof.

SPECIAL HAZARDS: Manual training hazards of woodworking and painting well safeguarded. Heating devices in domestic science and sewing rooms properly arranged and safeguarded.

EXPOSURES: Negligible from private dwelling property.

FIRST AID PROTECTION: Inadequate. One 2½ gallon chemical extinguisher on each floor and one 5 gallon pump extinguisher in basement, approved type.

PUBLIC PROTECTION: Full city protection; four well supplied triple hydrants available; fire station five blocks distant over paved and graded streets; two blocks to fire alarm box.

RECOMMENDATIONS

1. Install sufficient number of fire extinguishers.
2. Replace wood joisted floor over boiler room with fireproof floor and protect all openings to this room with approved automatic fire doors.
3. Do not operate electrical devices provided with pilot lights unless lights are in working order.
4. Provide safe means of egress to take care of maximum occupancy of second and third floors immediately, preferably smokeproof towers.
5. Trap to roof space should be hinged and covered with metal.
6. Eliminate combustible storage under stairways in basement.

SHERIDAN SCHOOL

MINNEAPOLIS, MINNESOTA

SCALE: 1 IN.=50 FT.

See new building

UNIVERSITY AV. N.E.

60'

4TH ST. N.E.

60'

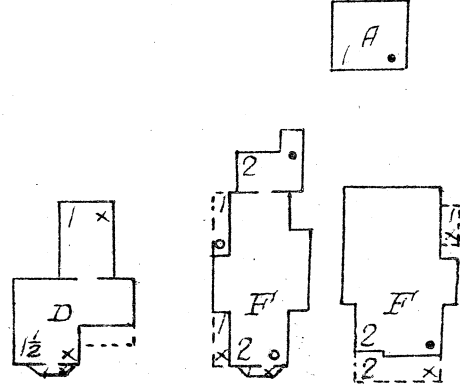
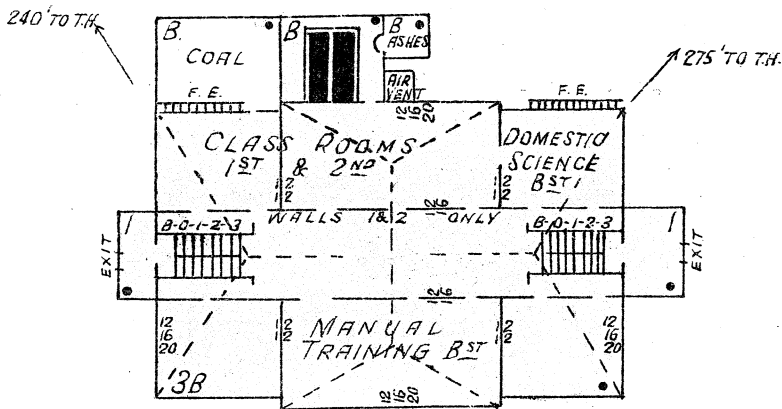

← 2 BLOCKS TO (FA)

6" W PIPE

T.H.
8" W PIPE

BROADWAY

60' TO T.H.

ERECTED	1896.
CONDITION	Fair to poor.
HEIGHT	One and three stories.
AREA	Bsmt., 10,900 sq. ft.; 1st, 9,975 sq. ft.; 2nd, 9,375 sq. ft.
WALLS	20, 16 and 12 in; brick joisted.
FLOORS	Ordinary wood joisted.
ROOF	Ordinary wood joisted with composition and metal surfacing.
FLOOR OPENINGS	Two open wood stairways from basement to 3rd floor.

