

SEWARD SCHOOL

28th Avenue S. and 24th Street E.

1931

Mr. Charles F. Hellberg, Principal

Originally Erected	1887
Number of Class Rooms	29
Number of Special Rooms	5
Enrollment	1149

SEWARD SCHOOL

This school is one of the older type of wood joisted brick constructed buildings with two fireproof floors in new section.

DETAILED REPORT

OCCUPANCY: Boiler room, manual training rooms, domestic science, playroom, lunch room, music room and storage room in basement. Auditorium, gymnasium and class rooms, first. Class rooms, second.

CARE AND MAINTENANCE: Fair to good. Plaster off walls and ceilings in spots.

EGRESS FACILITIES: Ample means of egress from all floors.

COMMON HAZARDS: LIGHT -- Electric with wiring in rigid conduit, installation as a whole good. Some non-standard portable cords and overfused circuits. HEAT -- Steam from one bank of two coal fired high pressure boilers in separate fireproof room not cut off. POWER -- Steam engine and electric motors. VENTILATION -- Metal ventilating ducts extend through roof.

SPECIAL HAZARDS: WOODWORKING -- Bench and power machine work, room cleaned daily. Metalworking and electrical work with gas solder furnaces safely arranged. PAINTING -- Occasional brush work, paint stock kept in metal cabinet and wooden bench drawer. Gas ranges and plates in teachers lunch room and domestic science room safely installed.

EXPOSURES: None.

FIRST AID PROTECTION: Poor protection afforded by chemical extinguishers deficient in number.

PUBLIC PROTECTION: Four triple head hydrants on 6 inch mains available within 400 feet. Fire department located three-fourths mile away over paved streets. Fire alarm within 400 feet.

RECOMMENDATIONS

1. Chemical extinguisher equipment should be made standard.
2. Openings to boiler room should be protected with approved three ply fire doors.
3. Electrical installation should be made to conform to rules of National Code.
4. Metal cabinet should be provided for paint stock in metal shop.
5. Broken light globe to illuminate exit sign from auditorium-gymnasium should be replaced and protected from mechanical injury.
6. Broken plaster in various places should be repaired.

SEWARD SCHOOL

MINNEAPOLIS, MINNESOTA

SCALE: 1 IN. = 50 FT.

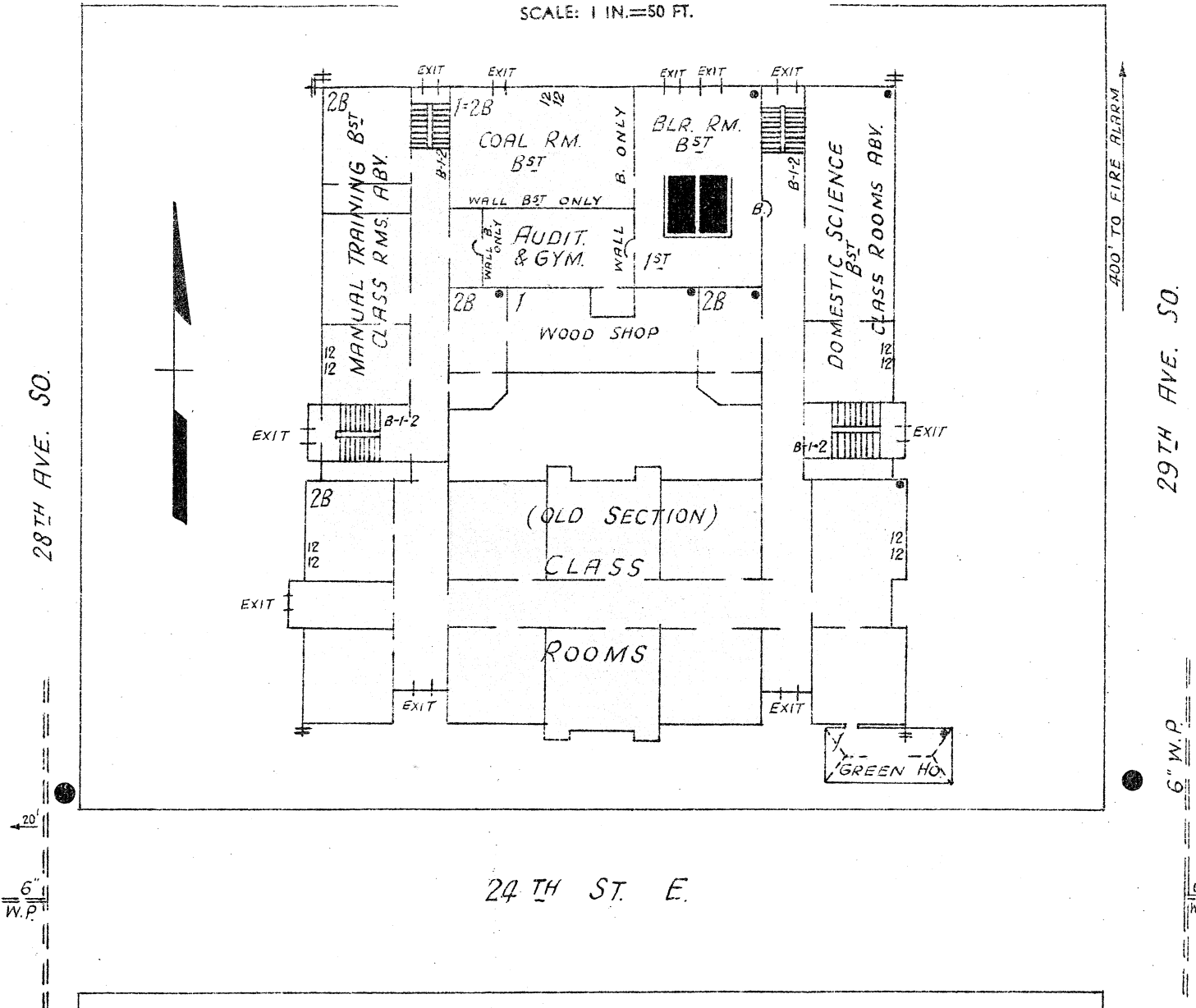

ERECTED 1887-addn's. 1901-1910-1916.
CONDITION Good.
HEIGHT One and two stories.
AREA Basement 33,750 Sq. Ft.
 First 34,350 Sq. Ft.
 Second 32,070 Sq. Ft.
WALLS Brick.
FLOORS Ordinary Wood.
 Joist, old section
ROOF Ordinary wood joist, tar and gravel;
 GLASS ROOF GREENHOUSE. SURF.
 Concrete, slab, new section.
FLOOR OPENINGS Four open stairs, basement to second.

