

SANFORD JUNIOR HIGH SCHOOL
42nd Avenue S. and 36th Street E.

1931

Mr. F. H. Forssell, Principal

Originally Erected	1926
Number of Class Rooms	28
Number of Special Rooms	6
Enrollment	1060

SANFORD JUNIOR HIGH SCHOOL

This school is one of the recent and better type, of mixed fireproof and incombustible construction.

DETAILED REPORT

OCCUPANCY: Boiler and engine room, lunch rooms, kitchen and storage in basement. Office, auditorium, manual training, electrical shop, and class rooms, first. Class rooms and gymnasium, second. Domestic science and class rooms, third.

CARE AND MAINTENANCE: Building comparatively new and receives excellent care.

EGRESS FACILITIES: Fair to good. No panic bars on auditorium exit doors and basement bicycle and storage room exit doors. Some paths of exit not clearly defined.

COMMON HAZARDS: LIGHT -- Electricity, wiring in conduit well installed. POWER -- Electricity, wiring in conduit. HEAT -- Steam from four coal fired, safely arranged, low pressure boilers located in separate fireproof room not cut off. VENTILATION -- Ventilating ducts carried through roof.

SPECIAL HAZARDS: WOODWORKING -- Bench work with small amount of power machinery well guarded. Wood shop cleaned daily. Metalworking and electrical work with small gas heated solder furnaces, safely arranged. PAINTING -- Occasional brush work with small paint stock kept in wooden cabinet. COOKING -- On gas ranges and plates safely arranged. Oil cooled transformers in non-standard vault. Gas drier in domestic science room.

EXPOSURES: None.

FIRST AID PROTECTION: Fair protection afforded by deficient supply of chemical extinguishers. Approved system of standpipe and hose covers entire building.

PUBLIC PROTECTION: Four double head hydrants on 6 inch and 8 inch mains available within 300 feet. Fire alarm box 400 feet away. Fire department one and one-half miles distant over paved and unpaved streets.

RECOMMENDATIONS

1. Chemical extinguisher equipment should be made standard.
2. Transformer vault should be made standard.
3. Unprotected opening to roof space should be supplied with metal covered trap door.
4. Boiler room should be cut off in standard manner.
5. Provide metal cabinet for paint storage.
6. Stage exits should be kept unobstructed at all times.
7. Install markers clearly indicating paths of exit where not clearly defined.
8. Panic bars should be provided for auditorium exit doors.

ERECTED	1926.
CONDITION	Excellent.
HEIGHT	One, two and three stories.
AREA	Basement 21,600 Sq. Ft., first 33,700 Sq. Ft., second 25,450 Sq. Ft., third 15,600 Sq. Ft.
WALLS	Panel, 8" hollow tile, 4" brick faced.
FLOORS	Reinforced concrete and tile, wood surfaced in class rooms.
ROOF	Auditorium, gypsum slab on unprotected steel metal lath and plaster ceiling. Balance, false wood roof on reinforced concrete and tile ceiling.
FLOOR OPENINGS	Three open stairs, basement to third, two open stairs basement to second, paper chute, dumbwaiter and elevator basement to third in hollow tile enclosure; metal glass panel doors on elevator openings. Wood doors balance.

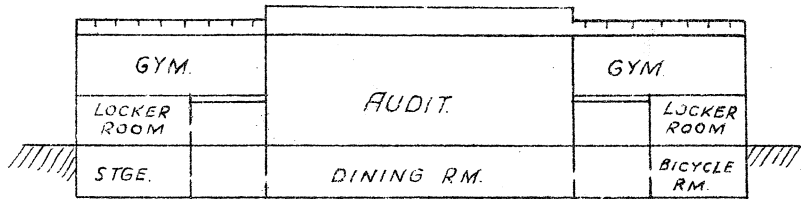

SECTION A-A

SANFORD JR. HIGH SCHOOL

MINNEAPOLIS, MINNESOTA

SCALE: 1 IN. = 50 FT.

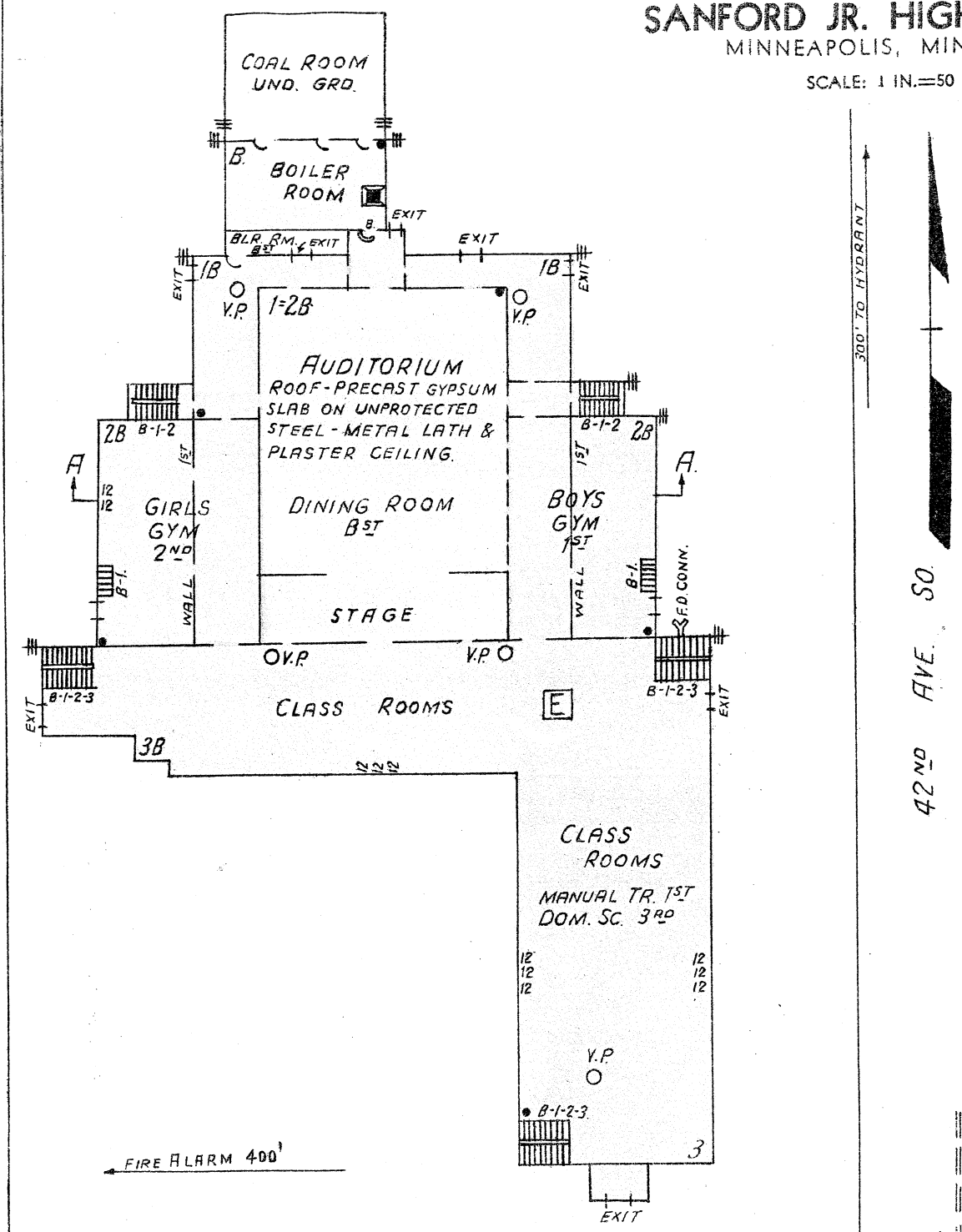

300' TO HYDRANT

42ND AVE. SO.

6" W.P.

8" W.P.I.P.E.

D.H.

D.H.

FIRE ALARM 400'

36TH STE.

