

PILLSBURY SCHOOL

23rd Avenue and Hayes Street N.E.

1931

C. E. Reichard, Principal

Originally Erected	1907
Number of Class Rooms	18
Number of Special Rooms	0
Enrollment	713

## PILLSBURY SCHOOL

Oldest sections of this building of quick burning interior construction. South addition is fireproof.

### DETAILED REPORT

OCCUPANCY: This building contains no special features.

CARE AND MAINTENANCE: Building in good repair and well maintained.

EGRESS FACILITIES: Stairways of ample width but so arranged that they might easily prove inadequate. Heavy automatic fire curtains on second and third floors could easily trap occupants in section with only one available stairway. Sixty foot dead end hallway on second and third floors in fireproof section. Stairways of wood and metal construction. Egress facilities as a whole poor.

COMMON HAZARDS: LIGHT -- Electric, with standard rigid conduit installation. Some oversize fuses. HEAT -- Steam boilers are located in non-fireproof room with tile ceiling on metal tees supported from wood second floor. VENTILATION -- Metal ventilating flues are carried through roof.

SPECIAL HAZARDS: COOKING -- Gas range and plate for teachers and community gatherings.

EXPOSURES: None.

FIRST AID PROTECTION: Two 1 quart and two 2½ gallon chemical extinguishers first and two 1 quart and one 2½ gallon chemical extinguishers second and third, approved type.

PUBLIC PROTECTION: Full city protection; four well supplied double hydrants available; five blocks to fire station over paved and graded streets; two blocks to fire alarm box.

### RECOMMENDATIONS

1. Provide sufficient chemical fire extinguishers.
2. Replace wood joisted floor over boiler room with fireproof floor and protect all openings to boiler room by approved automatic fire doors.
3. Replace oversize fuses on branch lighting circuits with those of not over 10 ampere capacity.
4. Opening to roof space in brick section should be protected by metal covered hinged trap.
5. Provide two safe exits from upper floors, preferably smoke proof towers, at approved locations.
6. Eliminate automatic closing feature on fire curtains or remove curtains.

# PILLSBURY SCHOOL

## MINNEAPOLIS, MINNESOTA

SCALE: 1 IN. = 50 FT.

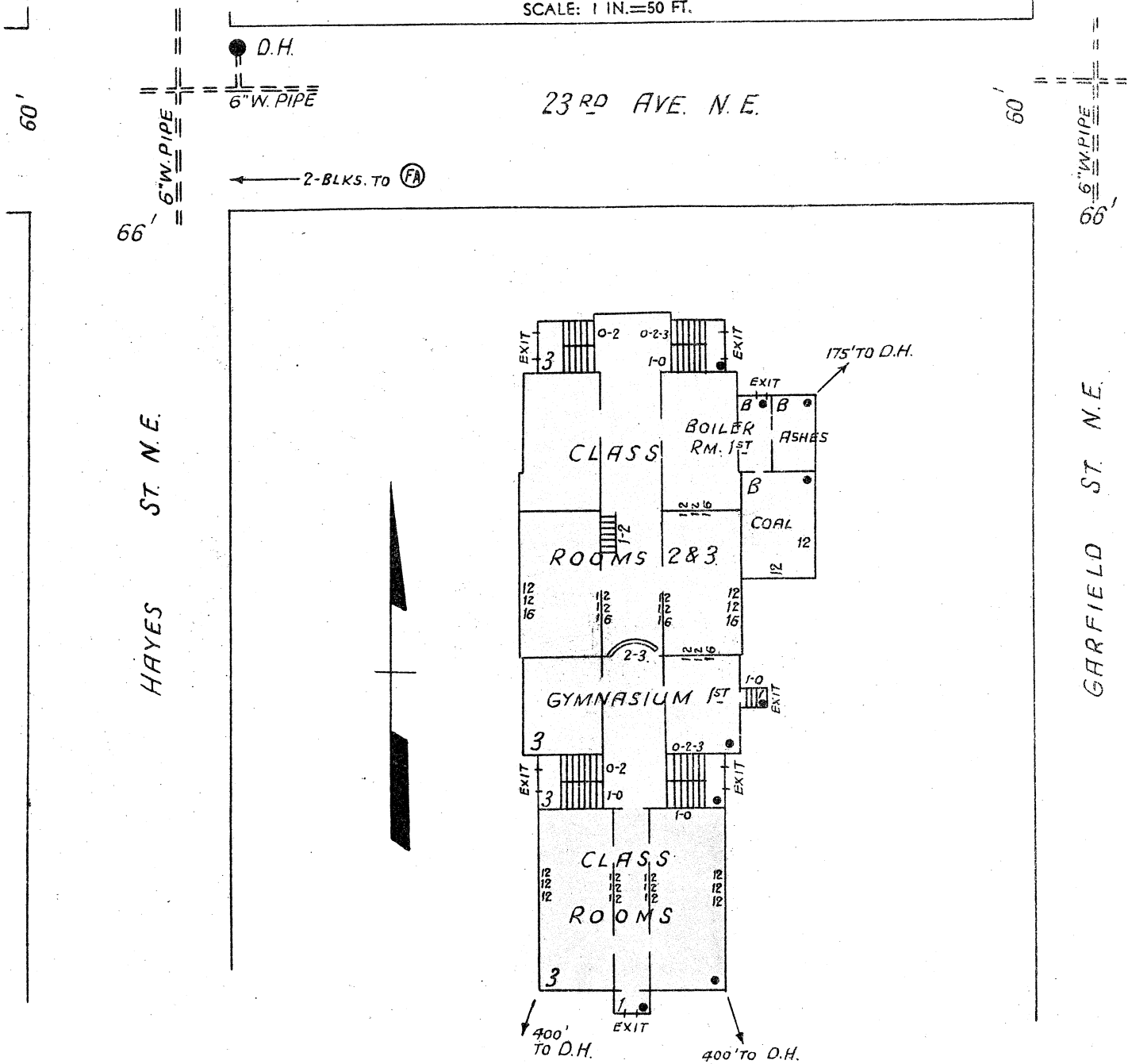

- ERECTED:** 1907, 1908, 1912 and 1923.
- CONDITION:** Good.
- HEIGHT:** One and three stories.
- AREA:** First, 16,130 Sq. Ft.; 2nd and 3rd, 14,630 Sq. Ft. each floor.
- WALLS:** 16" and 12" brick.
- FLOORS:** Ordinary wood joisted in brick section, 12" reinforced concrete joist and tile, wood surfaced, in fire resistive section.
- ROOF:** Ordinary wood joisted over entire building with composition surfacing and 12" reinforced concrete joist and tile slab ceiling under in fire resistive section.
- FLOOR OPENINGS:** Four open stairways from 1st to 2nd floor and two open stairways from 2nd to 3rd floor.

