

PIERCE SCHOOL

Broadway and Filmore Street N. E.

1931

Miss Ottelie J. Gaus, Principal

Originally Erected	1900
Number of Class Rooms	13
Number of Special Rooms	1
Enrollment	466

PIERCE SCHOOL

A two story brick structure of quick burning interior construction with a frame annex communicating through a frame and brick corridor 22 feet in length. Also a small ordinary frame portable used for gymnasium. Egress facilities are poor in main building.

DETAILED REPORT

OCCUPANCY: Small woodworking class in annex, remainder of school contains ordinary class rooms.

CARE AND MAINTENANCE: Buildings in fair repair. Housekeeping is good.

EGRESS FACILITIES: Good in frame buildings; poor in brick building; exits are provided direct to outside from each room in frame sections but interior vestibule doors are not free swinging; only one open wood stairway in brick section which would undoubtedly be blocked in the event of fire and necessitate the use of the inadequate metal fire escape.

COMMON HAZARDS: LIGHT -- Electric with standard rigid conduit installation except in west portable where wiring is open. Some oversize fuses. HEAT -- Steam boiler is located in non-fireproof basement room with non-standard door on opening to corridor.

VENTILATION -- Metal ventilating flues exhaust through roof.

SPECIAL HAZARDS: Painting in kindergarten in main building and in small woodworking class in annex; no metal paint storage cabinet provided in kindergarten and no waste cans provided in either room for oily rags.

EXPOSURES: None.

FIRST AID PROTECTION: Inadequate. One 1 quart extinguisher in west portable; five 1 quart and one 2½ gallon extinguishers in annex; one 2½ gallon extinguisher in basement and one 1 quart extinguisher on first and second floors, approved type.

PUBLIC PROTECTION: Full city protection; four well supplied double and triple hydrants available; three-fourths mile to fire station over paved streets; 175 feet to fire alarm box.

RECOMMENDATIONS

1. Install sufficient number of fire extinguishers.
2. Replace wood joisted floor over boiler room with floor of fireproof construction and protect all openings into this room with approved automatic fire doors.
3. Immediately provide safe means of egress from second floor, preferably a smokeproof tower.
4. Provide a metal storage cabinet for flammable paints used in kindergarten.
5. Provide approved waste cans in all rooms where oily waste is used.
6. Replace oversize fuses on branch lighting circuits with fuses of not over 15 amperes.
7. Hatch cover to roof space should be covered with metal and hinged.
8. Interior vestibule exit doors in frame sections should be made free swinging.
9. All oil and other combustible material should be removed from under stairways and exit in brick section.
10. Hand rails should be provided on all stairways.

PIERCE SCHOOL

MINNEAPOLIS, MINNESOTA

SCALE: 1 IN. = 50 FT.

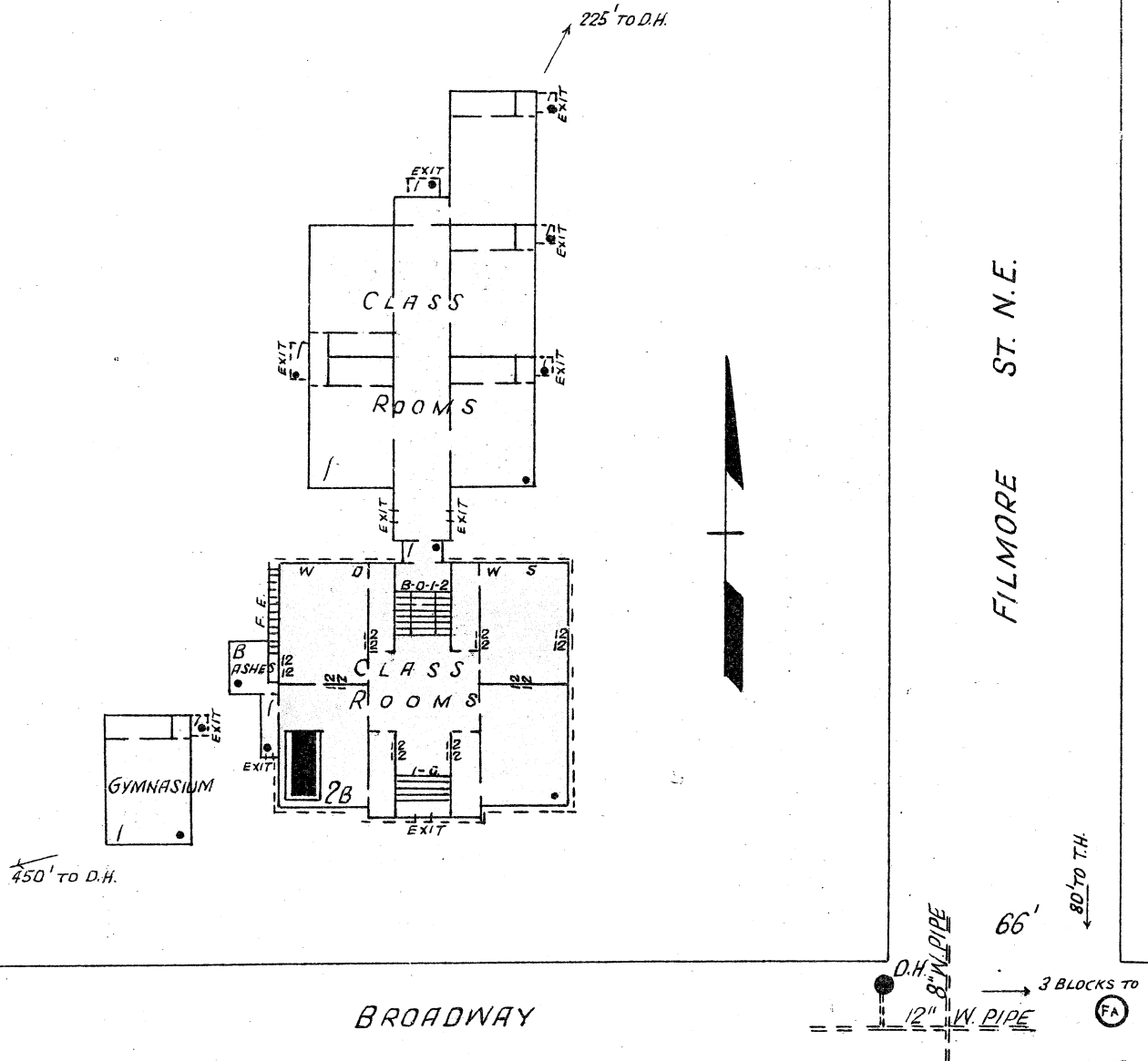

ERECTED: 1900.
CONDITION: Fair.
HEIGHT: Two stories.
AREA: Basement, 6100 Sq. Ft., 1st and 2nd, 5,800 Sq. Ft.
WALLS: 12" brick.
FLOORS: Ordinary wood joisted.
ROOF: Ordinary wood joisted with slate surfacing.
FLOOR OPENINGS: One open stairway basement to 2nd floor.

PORTABLES
 One story ordinary frame composition roofed structures.

