

LYNDALE SCHOOL

Lyndale Avenue South and
West 34th Street

1931

Mrs. Agnes M. Boysen, Principal

Originally Erected	1883
Number of Class Rooms	20
Number of Special Rooms	0
Enrollment	827

LYNDALE SCHOOL

Original building is among the older structures with quick burning wood interior. Later additions of semi-fireproof construction. Gymnasium is fireproof.

DETAILED REPORT

OCCUPANCY: This building contains no special features.

CARE AND MAINTENANCE: Building in good repair and very well maintained.

EGRESS FACILITIES: Egress facilities from this building are fair. Open stairways of adequate width but subject to smoke hazard from a single fire. Hazard exists in dead end hallway in old section that could be relieved by providing additional safe exit facilities. Fire escape of no value on north wall of old section.

COMMON HAZARDS: LIGHT -- Electric lights with wiring in metal conduit. Some oversize fuses. HEAT -- Steam boilers are located in fireproof basement room with non-standard doors on openings to corridor. VENTILATION -- Metal ventilating flues are carried through roof.

SPECIAL HAZARDS: Coffee making in teacher's lunch room on gas range, safe.

FIRST AID PROTECTION: Inadequate supply of first aid fire extinguishers, two in basement and on second floor and three on first floor.

PUBLIC PROTECTION: Full city protection; five well supplied hydrants; station nine blocks from risk over part paved streets; fire alarm box 200 feet.

RECOMMENDATIONS

1. Fire wall doors should be installed on openings to boiler and engine rooms. Pipe opening between boiler room and auditorium section should be filled with concrete.
2. Install sufficient chemical fire extinguishers.
3. Replace oversize fuses on branch lighting circuits with those of not over 10 ampere capacity.
4. Check steam piping and eliminate all contacts with combustible material.
5. Opening to cockloft in old section should be protected by hinged trap.
6. Place a substantial wire gate, to be kept locked, across opening to basement stairway in auditorium section.
7. Provide one safe means of egress from second floor at north end of old building, either smokeproof tower or ramp.

LYNDALE SCHOOL

MINNEAPOLIS, MINNESOTA

SCALE: 1 IN. = 50 FT.

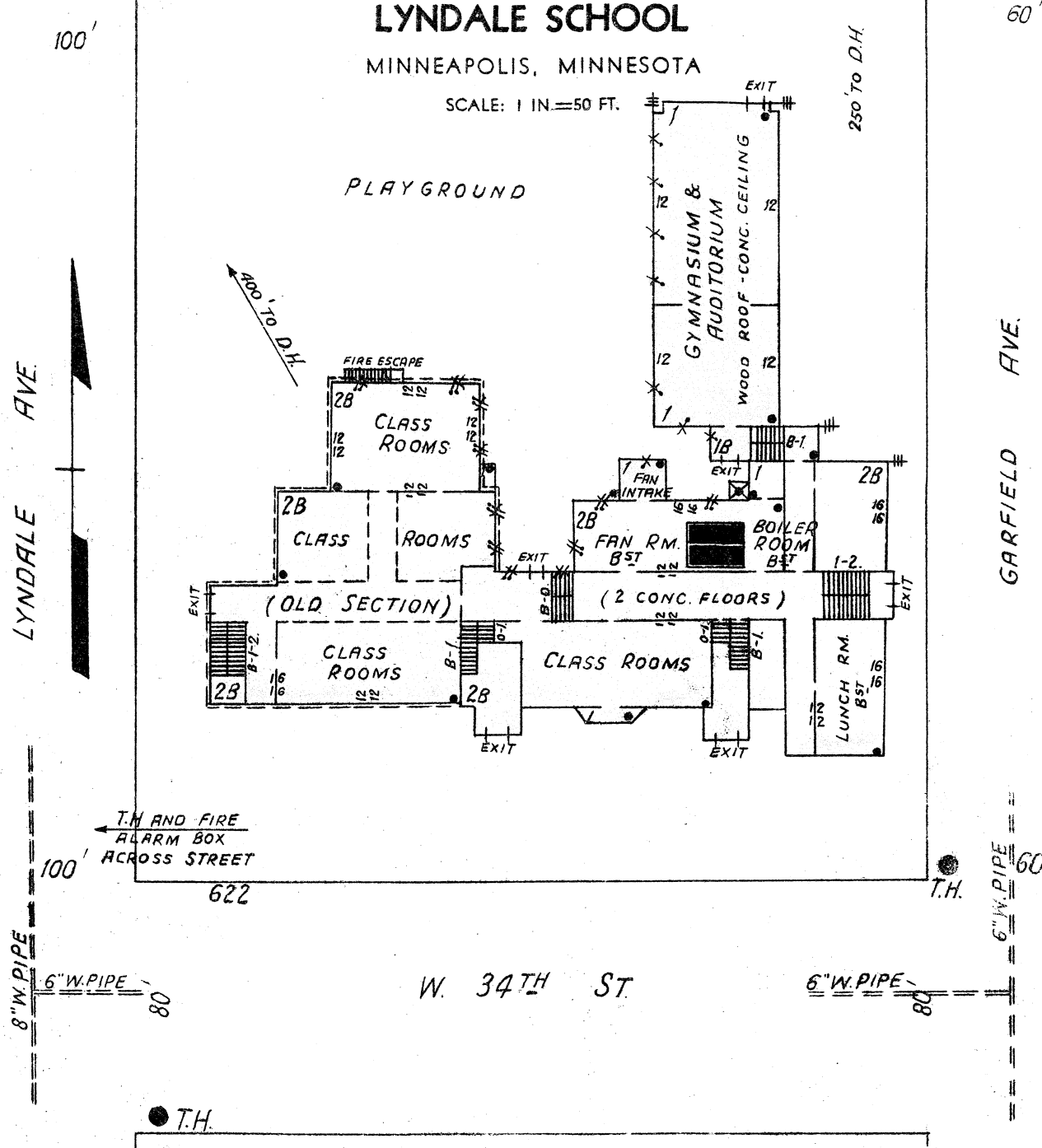

ERECTED
CONDITION
HEIGHT
AREA

1883, 1908, 1915 and 1927.

Good.

One and two stories.

First floor, 20,272 Sq. Ft.; basement and second floor, 35,964 Sq. Ft. on each.

WALLS:
FLOORS

12" and 16" brick.

Ordinary wood joisted in old section; reinforced concrete elsewhere.

ROOF

Ordinary wood joisted with composition and gravel surfacing.

FLOOR
OPENINGS

Three open stairways basement to first two open stairways first to second.

