

FULTON SCHOOL

Vincent Avenue S. and 49th Street W.

1931

Mrs. Blanche Neville, Principal

Originally Erected	1915
Number of Class Rooms	24
Number of Special Rooms	2
Enrollment	1050

FULTON SCHOOL

A modern one and two story school building of fireproof and semi-fireproof construction with fairly good egress facilities. Two small frame portables for sixth grade classes with good facilities for egress.

DETAILED REPORT

OCCUPANCY: No special features except manual training, domestic science and community kitchen, all located in basement.

CARE AND MAINTENANCE: Building in excellent condition, well maintained.

EGRESS FACILITIES: Egress facilities from this building are barely adequate for present enrollment. Only two stairways from second floor. Blind end hallways 120 feet long exist on the first and second floors and some means should be provided to eliminate this condition. One exit door from each portable building.

COMMON HAZARDS: LIGHT -- Electric, standard conduit wiring.

HEAT -- Two high pressure steam boilers in fireproof room, not properly cut off. VENTILATION -- Metal ventilating flues exhaust through roof.

SPECIAL HAZARDS: Manual training with a small amount of finishing. Hazards well protected. Domestic science, occasional cooking for teachers and community kitchen; gas heated devices safely installed.

EXPOSURES: None.

FIRST AID PROTECTION: Poor. Only two approved fire extinguishers basement, none first and second.

PUBLIC PROTECTION: Full municipal fire protection. Four available hydrants. Fire alarm box one-half block distant. Nearest fire station is one mile, streets partly paved.

RECOMMENDATIONS

1. A standard firewall door should be installed on opening from fan room to boiler room.
2. A sufficient number of approved fire extinguishers should be distributed.
3. Protect all openings to roof space with standard fire doors.
4. Repair projection openings in motion picture booth in order to make them automatic closing.
5. Keep exit doors from kindergarten room in northeast corner of basement unlocked at all times during school hours and remove all obstructions blocking this exit.
6. Protect steam radiators in cloak rooms of portables to prevent clothing from coming in contact.
7. Provide additional stairway at west end of each wing of building.

FULTON SCHOOL

MINNEAPOLIS, MINNESOTA

SCALE: 1 IN. = 50 FT.

D.H.

D.H.

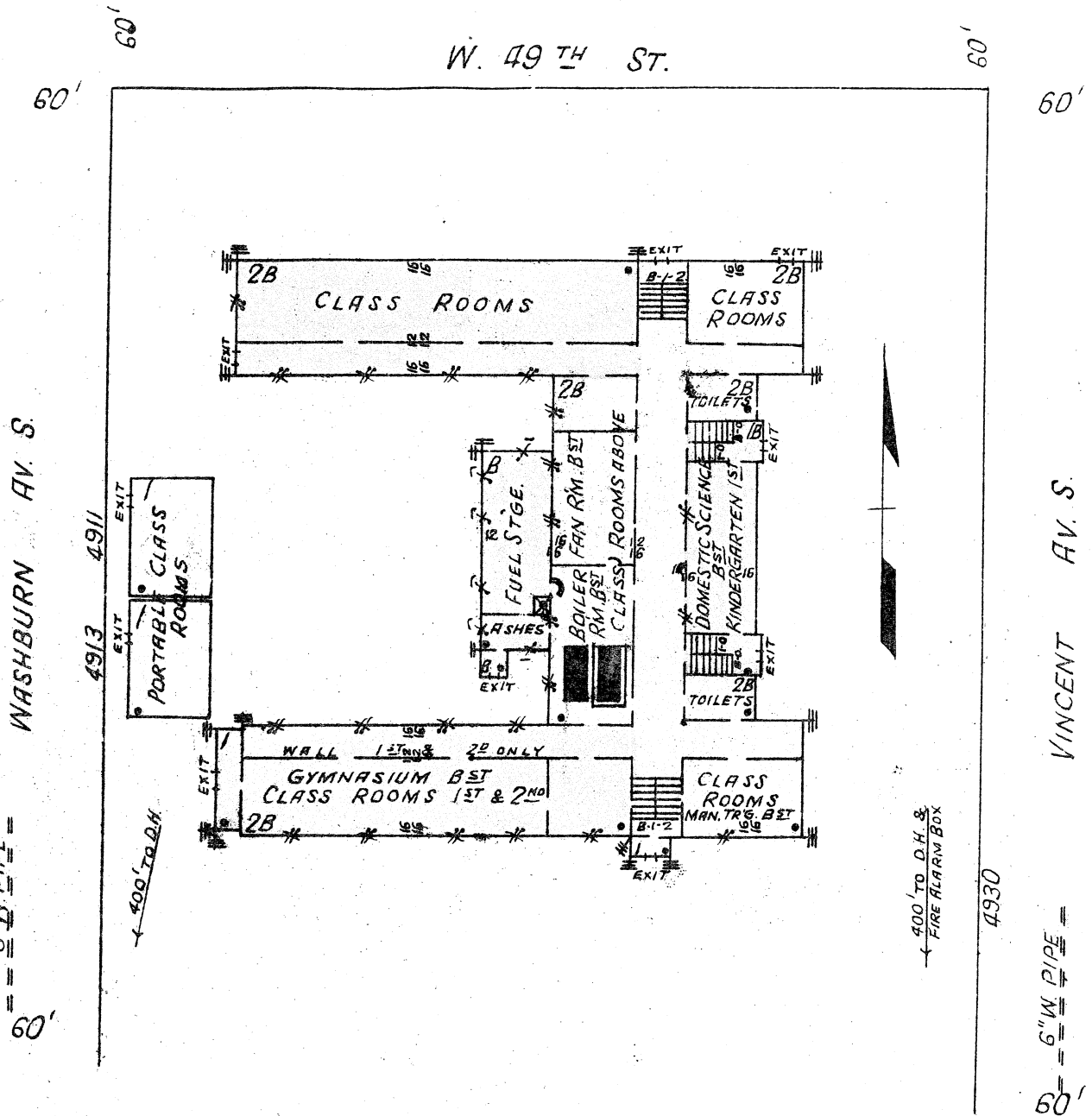

ERECTED: 1915, 1922.
CONDITION: Good.
HEIGHT: One and two stories.
AREA: Bsm't. 19,426 sq. ft.; 1st 18,294 sq. ft.; 2nd 16,376 sq. ft.
WALLS: 16" brick and brick and tile.
FLOORS: Reinf. conc.
ROOF: Fireproof sections have ordinary wood joisted roof, gravel surfaced with reinf. conc. ceiling beneath, except boiler room and one story section which has reinf. conc. roof. Brick section has ordinary wood joisted roof, metal lath and plaster ceiling beneath.
FLOOR OPENINGS: Four open stairways bsm't. to 1st, two open stairways 1st to 2nd.
PORTABLES: Ordinary frame.

