

FRANKLIN JUNIOR HIGH SCHOOL

404-416 15th Avenue N.

1931

Mr. S. O. Severson, Principal

Originally Erected	1917
Number of Class Rooms	22
Number of Special Rooms	5
Enrollment	690

FRANKLIN JUNIOR HIGH SCHOOL

A one and two story structure with wood floors and roof and a one and two story addition with part concrete slab and part gypsum roof.

DETAILED REPORT

OCCUPANCY: Manual training, boiler room, gymnasium, swimming pool and lunch room, basement. Auditorium, office, library, art room, sewing rooms and class rooms, first. Music room, domestic science and class rooms, second.

CARE AND MAINTENANCE: Building in poor repair. Premises orderly.

EGRESS FACILITIES: Fair. Fireproof stairways throughout only deficiency exists in northwest section of old building where there is a blind pocket.

COMMON HAZARDS: LIGHT -- All electric wiring in rigid conduit. HEAT -- Steam from high pressure boilers in separate fireproof room. VENTILATION -- All vents ducts carried through roof.

SPECIAL HAZARDS: WOODWORKING -- Seven small machines in addition to benches, refuse cleaned up after each class and removed daily.

PAINTING -- Brush work only, good metal cabinet for paints and oils and an approved self-closing metal can for paint rags.

METALWORKING -- Hand work, four small gas plates. PRINTING -- Two small presses, one gallon gasoline, approved container.

EXPOSURES: None.

FIRST AID PROTECTION: None except a deficient number of chemical fire extinguishers.

PUBLIC PROTECTION: Good public protection, five triple hydrants conveniently located on six inch water mains, four fire departments within one mile, paved streets intervening.

RECOMMENDATIONS

1. Install a self-closing device on boiler room doors.
2. Install a sufficient number of approved 2½ gallon chemical fire extinguishers.
3. Install a safe means of exit from northwest corner of main building where a blind pocket exists.

T.H.

(FA)

FRANKLIN JR. HIGH SCHOOL

MINNEAPOLIS, MINNESOTA

SCALE: 1 IN. = 50 FT.
16TH AVE. N.

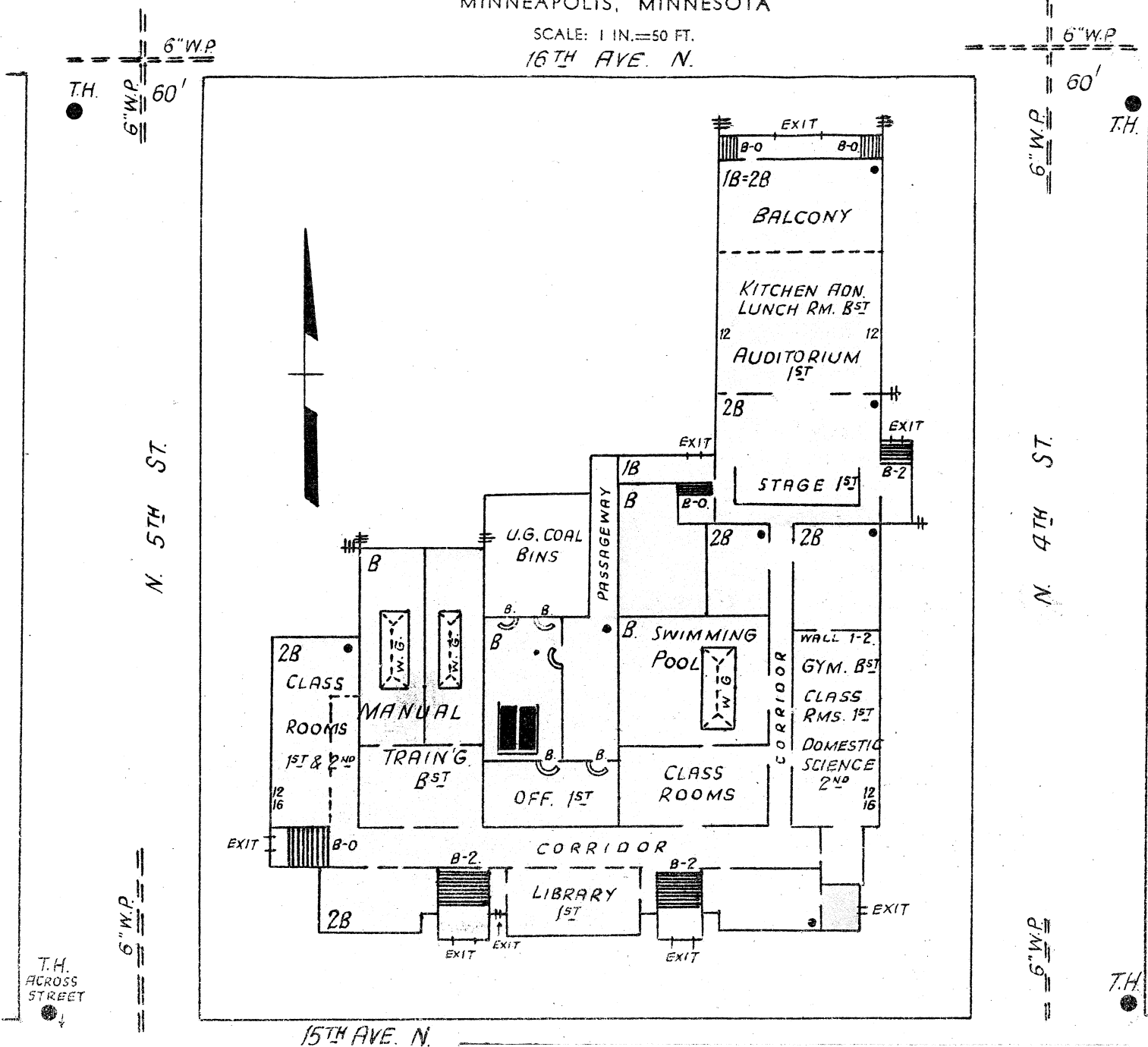

- ERECTED:** 1917-1924.
- CONDITION:** Fair.
- HEIGHT:** One and two stories.
- AREA:** 34,900 Sq. Ft. Bst., 24,575 Sq. Ft. 1st, 19,000 Sq. Ft. 2nd.
- WALLS:** 16" and 12" brick and brick and H. T.
- FLOORS:** Ordinary wood floor except auditorium section reinforced concrete.
- ROOF:** Composition on 7/8" boards on main bldg. Gypsum on unprotected steel over auditorium.
- FLOOR OPENINGS:** Seven open stairways basement to 1st.
- OPENINGS:** Three open stairways 1st to 2nd.

