

FOLWELL JUNIOR HIGH SCHOOL

E. 36th St. Between 20th and 21st Aves. S.

1933

Mr. S. O. Severson, Principal

Originally Erected	1931
Number of Class Rooms	25
Number of Special Rooms	6
Enrollment	940

This is a new school building of junior high grade and is of fire-resistive construction with the exception of unprotected steel in roof of auditorium and shop sections.

DETAILED REPORT

OCCUPANCY: Basement, boiler room, transformer vault, pump room, cafeteria, kitchen, boys' gymnasium. First floor, auditorium with stage and small amount of scenery, manual training, metal working, electrical shop, printing and usual class rooms. Second floor, girls' gymnasium. Third floor, domestic science. Usual class rooms on second and third floors.

FOLWELL JUNIOR HIGH SCHOOL -- Continued

CARE AND MAINTENANCE: Building new and in good repair. Well maintained.

EGRESS FACILITIES: Good. Four open stairways well located and of adequate width. Egress facilities from building as well as from auditorium and lunch room where large numbers gather, adequate. Direct outside exits from basement, having panic bars where needed.

COMMON HAZARDS: LIGHT -- Electric, wiring in conduit, commercial service, good installation. HEAT -- Three low pressure steam boilers in fireproof basement room communicating with remainder of building through metal clad automatic closing doors not labeled. Oil fuel using pump feed from 12,000 gallon buried outside tank. Anti-siphoning device in line, safe. VENTILATION -- Metal vent duct carried to ventilating chambers in attic; vent chambers of masonry construction and discharge above roof.

SPECIAL HAZARDS: The hazards consisting of vocational training are confined largely to the rear section of the first floor. Training consists of wood and metal working, electrical shop, printing shop; domestic science and sewing for the girls. All gas heated devices consisting of soldering iron heaters, gas plates in domestic science room, gas ranges and ovens in baking room, domestic science room and cafeteria kitchen, all safely arranged with permanent connections. Electric irons and glue pots equipped with pilot lights. One quart of gasoline in approved can in print shop with one gallon unapproved container also in shop. Two gallons of Thenoid type cleaner (comparable with kerosene) kept in print shop.

EXPOSURES: None.

FIRST AID PROTECTION: Five standpipe and hose outlets on each floor with 100 feet of good hose at each outlet. An inadequate number of approved fire extinguishers are distributed in such quantity as to be of considerable value. All equipment well maintained and well placed.

PUBLIC PROTECTION: Full city protection. Adequate number of hydrants nearby. Ten blocks to fire station. Fire alarm box on corner.

RECOMMENDATIONS

1. Install adequate number of fire extinguishers.
2. Remove the extra one gallon unapproved can of gasoline from print shop and prohibit the storage of gasoline in any other than approved containers.
3. Provide drain in transformer vault.

Scale: 1"=50'

E. 36<sup>th</sup> ST.

6" W. PIPE

20<sup>th</sup> AV. SO.

6" W. PIPE

21<sup>st</sup> AV. SO.

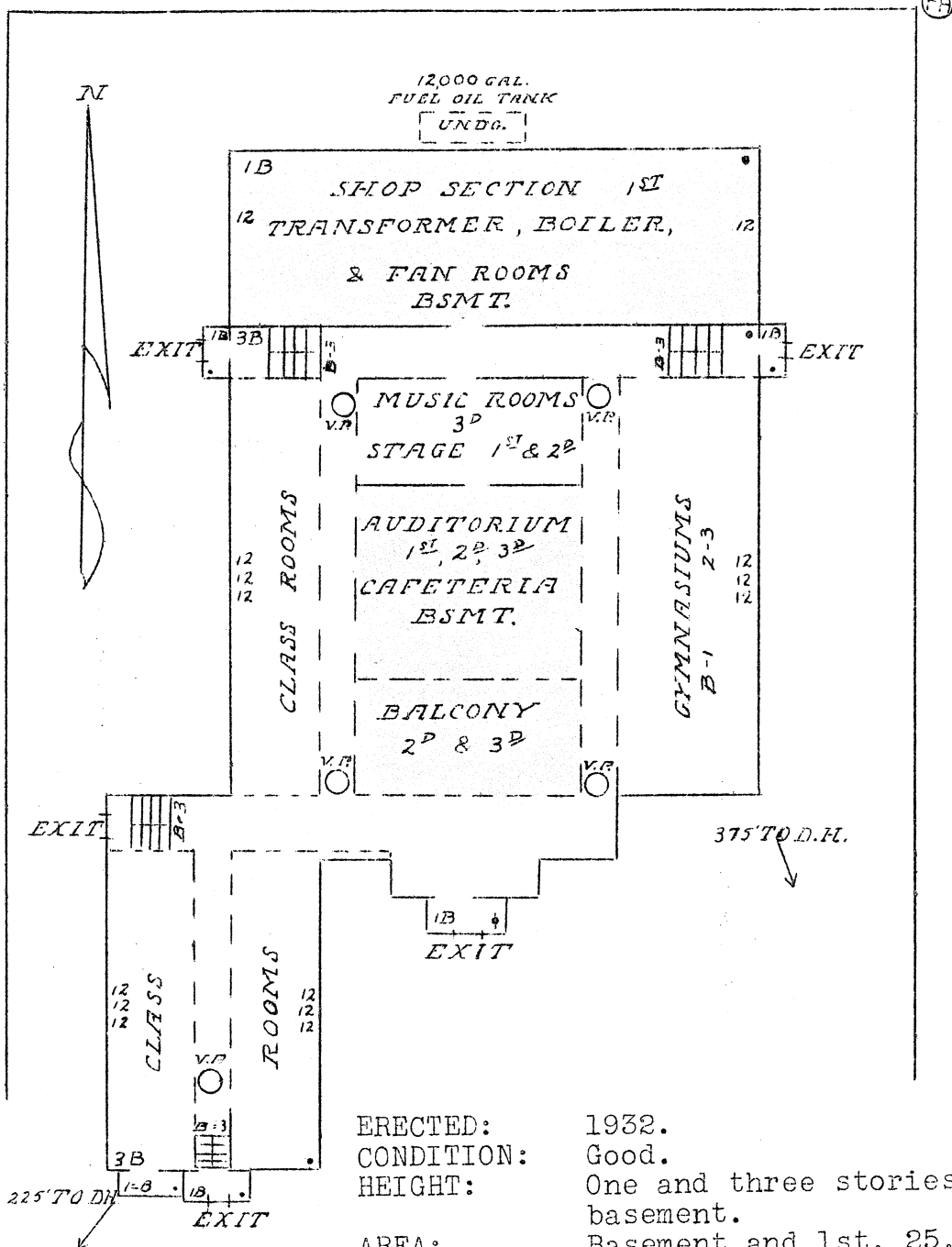

ERECTED: 1932.  
 CONDITION: Good.  
 HEIGHT: One and three stories with basement.  
 AREA: Basement and 1st, 25,400 sq. ft.; 2nd and 3rd, 17,900 sq. ft.  
 WALLS: 12" brick, panel construction.  
 FLOORS: Reinforced concrete joist and slab, wood surfacing in class rooms.  
 ROOF: False wood over concrete slab ceiling except over auditorium and shop section which is of steel truss construction with gypsum roof.

FLOOR OPENINGS: 4 open stairways basement to 3rd; 1 dumb-waiter in hollow tile shaft basement to 3rd with wood doors on basement & 3rd floor openings; no outlets on other floors.