

CLEVELAND SCHOOL
2310 Lowry Avenue N.

1931

Miss G. Drohan, Principal

Originally Erected	1927
Number of Class Rooms	19
Number of Special Rooms	0
Enrollment	573

CLEVELAND SCHOOL

A two and one story fireproof structure with concrete floors and ceiling and false wood roof.

DETAILED REPORT

OCCUPANCY: Boiler room, generator and battery room, stock room and transformer room, basement. Office, teachers' lunch room, auditorium, gymnasium and class rooms, first. Class rooms, second.

CARE AND MAINTENANCE: Building in very good repair and premises neat and orderly.

EGRESS FACILITIES: Good. Four stairways from first to second floor.

COMMON HAZARDS: LIGHT -- Electric, wiring in rigid conduit in good condition. HEAT -- Steam from low pressure boilers in separate fireproof room in basement, no approved cut off. VENTILATION -- Metal ducts carried through roof.

SPECIAL HAZARDS: None.

EXPOSURES: Light from small dwellings and out buildings.

FIRST AID PROTECTION: None except a deficient number of chemical fire extinguishers.

PUBLIC PROTECTION: Fair, ample water supply afforded by two double hydrants on 12 inch water mains, one fully equipped fire department within one mile, paved streets intervening.

RECOMMENDATIONS

1. Install a sufficient number of approved 2½ gallon chemical fire extinguishers.
2. Install an automatic closing equipment on fire door leading to boiler room.
3. Remove table from corridor on second floor.

CLEVELAND SCHOOL

MINNEAPOLIS, MINNESOTA

SCALE: 1 IN. = 50 FT.

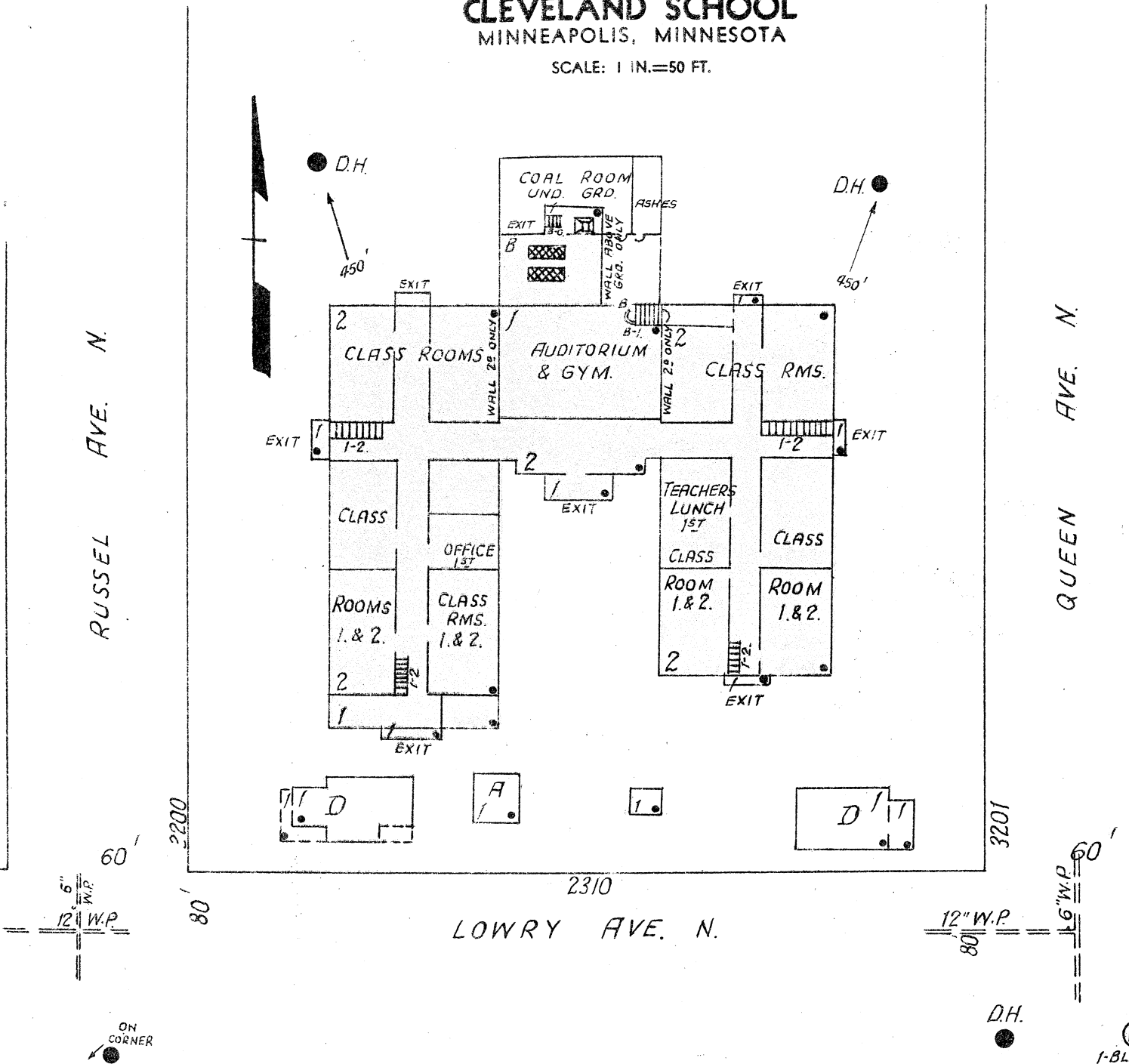

ERECTED: 1927.
CONDITION: Excellent.
HEIGHT: One and two stories.
AREA: Basement, 3,500 Sq. Ft.
 First, 19,500 Sq. Ft.
 Second, 17,100 Sq. Ft.
WALLS: 8" HT 4" brick.
FLOORS: Reinforced concrete.
ROOF: Composition surfacing on 7/8" boards on wood joists on wood supports resting on concrete slab.
FLOOR OPENINGS: One enclosed, basement to first self closing fire wall door basement Four open in hallway, first to second.

