

AUDUBON SCHOOL

Chowen Avenue S. and W. 41st Street

1931

Miss Florence Gee, Principal

Originally Erected	1924
Number of Class Rooms	8
Number of Special Rooms	0
Enrollment	321

AUDUBON SCHOOL

A small one and two story school of modern fireproof construction. Egress facilities are fair.

DETAILED REPORT

OCCUPANCY: Building presents no special features.

CARE AND MAINTENANCE: Building is new. Good maintenance.

EGRESS FACILITIES: Fair. Only one stairway from second floor. An additional exit door is provided from the second floor leading onto a wooden stairway or fire escape. This stairway is entirely uncovered and exposed by a window under landing on the first floor. Exit doors from first floor are adequate.

COMMON HAZARDS: LIGHT -- Electric, standard conduit wiring.

HEAT -- One low pressure steam boiler in fireproof room not properly cut off. VENTILATION -- Foul air is exhausted through metal ducts into a combustible chamber in roof space where it is recirculated or exhausted to outside.

SPECIAL HAZARDS: None.

EXPOSURES: None.

FIRST AID PROTECTION: One approved fire extinguisher on each floor. None in basement.

PUBLIC PROTECTION: Full city protection. Three hydrants nearby. No fire alarm box within three blocks. Nearest fire station ten blocks, streets mostly unpaved.

RECOMMENDATIONS

1. Protect opening to roof space with approved fire door and relocate ladder in roof space to allow normal closing of the fire door at this point.
2. Provide a standard cut off for boiler room.
3. Distribute a sufficient number of approved fire extinguishers.
4. Entirely line combustible foul air chamber in roof space with a continuous metal duct.

AUDUBON SCHOOL

MINNEAPOLIS, MINNESOTA
SCALE: 1 IN. = 50 FT.

60'

6" W. PIPE

CHOWEN AVE. SO.

6" W. PIPE

60'

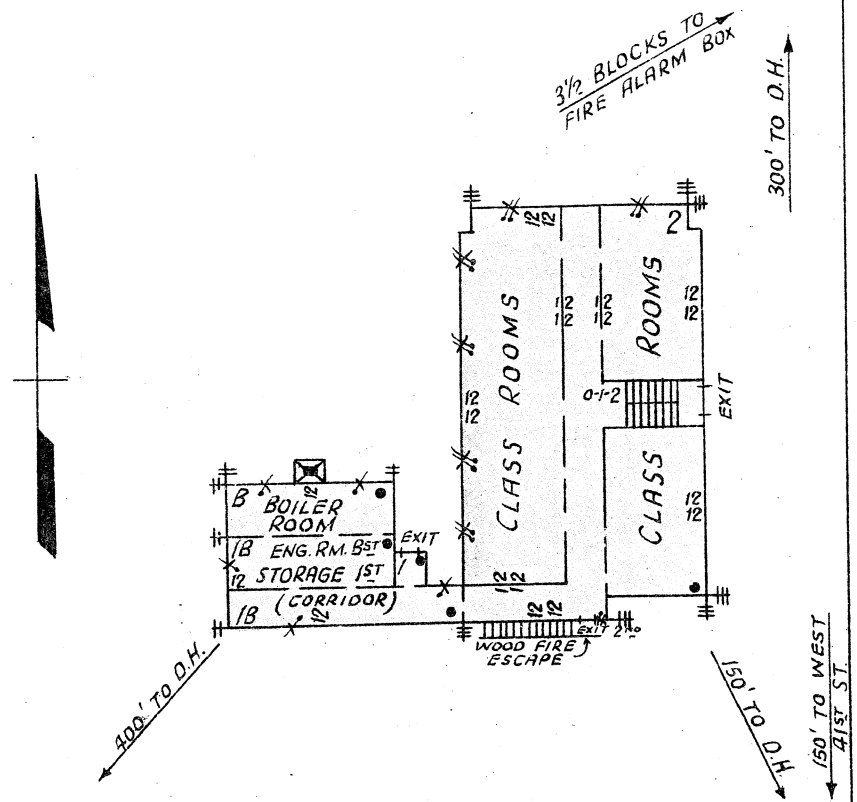

- ERECTED** 1924.
- CONDITION:** Good.
- HEIGHT** One and two stories.
- AREA** Bsmt. 1,771 sq. ft., 1st 8,425 sq. ft., 2nd 6,654 sq. ft.
- WALLS:** 12" brick panel walls in skeleton frame of reinf. conc.
- FLOORS:** Reinf. conc. joist.
- ROOF:** Ordinary wood joisted, gravel surfaced, with conc. slab ceiling beneath.
- FLOOR OPENINGS:** One open stairway, 1st to 2nd.

